

New Hampshire Land Surveyors Association

54th Annual Meeting & Equipment Show

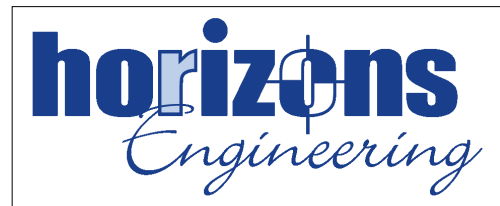

Meet Our Sponsors

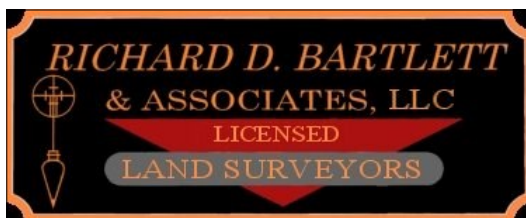

December 7–8, 2023

**DoubleTree by Hilton
Manchester Downtown**

700 Elm Street, Manchester, NH



PROGRAM AT A GLANCE

NHLSA 54th Annual Meeting & Equipment Show

Thursday
December 7, 2023

7:30 AM

◆ **Registration Desk Open (Assembly)**

◆ **Continental Breakfast (Assembly)**

Freshly baked assorted muffins & breakfast pastries, diced fresh fruit, whole fruit, orange, cranberry & apple juice, freshly brewed regular & decaffeinated coffee, and selection of teas

(Pemigewasset Room)

8:00 AM—10:00 AM

◆ **Session 1: Professional Track: James D. Nadeau—Increasing Your Professional Value, Professional Document for Liability Protection, and Becoming a Flood Consultant (2.0 CEUs)**

(Merrimack/Contoocook Rooms)

8:00 AM—10:00 AM

◆ **Session 2: Technician Track: Dane M. Courville, PLS—PLSS Breakdown; Single and Double Proportioning; Horizontal Curves; and Vertical Curves (2.0 CEUs)**

10:00 AM—10:15 AM

◆ **Morning Break (Assembly)**

Freshly brewed regular and decaffeinated coffee and selection of teas

10:15 AM—12:00 PM

◆ **Session 1 & 2: continued**

12:00 PM—1:00 PM

◆ **Lunch Buffet (Assembly)**

Lunch at your Leisure: **Sandwiches—Choose One: Grilled Seasonal Vegetables with basil mayo/Wrap; Roast Sirloin with whole grain mustard, Swiss cheese, red onion jam/Baguette; Roasted Turkey Breast with Smoked Gouda, Chipotle mayo/Wrap**; All lunches include the following sides: Cape Cod chips, freshly whole fruit, pasta salad, dark chocolate chip cookie, bottled water; selection of sodas

1:00 PM—2:15 PM

◆ **Session 1 & 2 Continued**

2:15 PM—2:30 PM

◆ **Afternoon Break (Assembly)**

Selection of sodas & bottled water, freshly brewed regular coffee & decaffeinated coffee, selection of teas, trail mix station

2:30 PM—3:30 PM

◆ **Session 1 & 2: continued**

3:30 PM—4:00 PM

◆ **Seminar wrap-up, Q&A, & Committee Meetings**

4:00 PM—6:00 PM

◆ **Business Meeting, Awards (Pemigewasset Room)**

6:00 PM—7:00 PM

◆ **Reception (Assembly)**

Hors d'oeuvres: Vegetable spring rolls, charred lime chili sauce; Smoked bacon wrapped scallops, sweet mustard sauce; Farmers Market (cucumbers, baby carrots, grilled baby zucchini, squash, asparagus, red bell peppers, sugar snap peas, French green beans with coriander blue cheese dressing, chili lime ranch dressing, and sweet garlic aioli dip; Domestic cheese display

◆ **Foundation Live Benefit Auction featuring Terry Eldredge.**

7:00 PM—9:00 PM

◆ **Buffet Banquet (Three Rivers—Piscataquog, Merrimack, Contoocook)**

Entrée Choices: Espresso-Rubbed Sirloin of Beef; Crispy Chicken Roulade (Roasted tomato, basil, smoked Gouda stuffing); Sea salt Roasted Red Creamer Potatoes and Roasted Asparagus. Both to include: a selection of Freshly Baked Breads, Freshly Brewed Regular & Decaffeinated Coffee, and Selection of Teas. First course New England Clam Chowder and Mixed Baby Lettuce with cucumber, tomatoes, carrots, and Chili Lime Ranch; Dessert: Blueberry Chambord Cheesecake.

◆ **Entertainment: Dancing Madly Backwards Band.**

REGISTRATION—ASSEMBLY

BADGES REQUIRED - ALL EVENTS

Please help your fellow members and guests identify you by name by wearing your badge. (meal tickets included in your badge)

**Session 20:
Certified Survey
Technicians Program
1:00 - 5:00**

Note: Please advise of any special meal requests, e.g., vegetarian, gluten-free, etc., when you RSVP.

PROGRAM AT A GLANCE

NHLSA 54th Annual Meeting & Equipment Show

**Friday
December 8, 2023**

7:30 AM

◆ **Registration Desk Open (Assembly)**

◆ **Continental Breakfast (Armory)**

Same as Thursday

7:30 AM—9:00 AM

◆ **Past Presidents' Breakfast (Piscataquog Room)**

The American: Seasonal fruit & fresh berries; Assorted French breakfast pastries; Applewood smoked bacon; Cage-free scrambled eggs (snipped chives); Breakfast creamer potatoes (sweet onions, fresh herbs); Individual yogurt parfaits (Greek yogurt, fresh berries, house-made granola); Fresh chilled fruit juices; Freshly brewed regular & decaffeinated coffee, and a selection of teas

8:00 AM—4:00 PM

◆ **Exhibit Hall Open (Armory)**

Concurrent Sessions

8:00 AM—10:00 AM

◆ **Session 3: A Case Study: Legal Aspects for Survey Technicians on the Path to Licensure (Pemigewasset Room)**

8:00 AM—9:00 AM

◆ **Session 4: NH Registry of Deeds—Protecting the Past, Processing the Present, and Preparing for the Future (Frost Room)**

8:00 AM—10:00 AM

◆ **Session 5: Top 10 Practical Lessons for Being an Effective Land Surveyor in Court (Dartmouth Room)**

8:00 AM—10:00 AM

◆ **Session 6: Update on Grav-D and Progress Toward a New Vertical Datum (Contoocook Room)**

8:00 AM—10:00 AM

◆ **Session 7: Rules of Construction (Merrimack Room)**

9:00 AM—10:15 AM

◆ **Session 8: Navigating the NH Shoreland Protection Act and Recognizing Common Pitfalls (Frost Room)**

9:30 AM—10:30 AM

◆ **Session 9: NESS Roundtable (Piscataquog Room)**

10:00 AM—10:15 AM

◆ **Morning Break (Armory)**

Same as Thursday

10:15 AM—12:15 PM

◆ **Session 10: Panel Discussion: Business Ownership from the Perspective of Seasoned and Young Professionals (Pemigewasset Room)**

REGISTRATION—ASSEMBLY

10:30 AM—12:30 PM

◆ **Session 11: Railroads in New Hampshire (Frost Room)**

10:15 AM—12:15 PM

◆ **Session 12: Micro Topics in Surveying (Dartmouth Room)**

10:15 AM—12:15 PM

◆ **Session 13: Surveying Software and Technologies (Contoocook Room)**

10:15 AM—11:15 AM

◆ **Session 14: Best Practices for Using Base/Rover GNSS (Merrimack Room)**

11:15 AM—12:15 PM

◆ **Session 15: NHDES Subsurface Bureau Legislation Update (Merrimack Room)**

10:30 AM—12:30 PM

◆ **Session 16: New England Women Surveyors Roundtable (Piscataquog Room)**

12:00 PM—2:00 PM

◆ **Session 17: Exclusive Viewing of Exhibit Hall (Armory)**

12:00 PM—2:00 PM

◆ **Lunch Buffet (Armory)**

Lunch at your Leisure: Sandwiches—Choose One: Grilled Seasonal Vegetables with Basil Mayo/ Wrap; Roast Sirloin with whole grain mustard, Swiss cheese, red onion jam/Baguette; Grilled Chicken Breast with Pesto, tomato, provolone/ Ciabatta Bread; All lunches include the following sides: Cape Cod chips, freshly whole fruit, pasta salad, dark chocolate chip cookie, bottled water; selection of sodas

Concurrent Sessions Continued

2:00 PM—4:00 PM

◆ **Session 18: Technical Topics on Civil 3D for the Surveyor (Pemigewasset Room)**

2:00 PM—4:00 PM

◆ **Session 19: Young Surveyors Roundtable (Frost Room)**

3:00 PM—3:15 PM

◆ **Afternoon Break (Armory)**

Same as Thursday; swap out trail mix for Selection of Freshly Baked Cookies and Brownies

2:00 PM—4:00 PM

◆ **Session 21: The Zoning Board of Adjustment Strategies for Surveyors and Traps for the Unwary (Contoocook Room)**

2:00 PM—4:00 PM

◆ **Session 22: The Certified Floodplain Surveyor (Merrimack Room)**

2:00 PM—4:00 PM

◆ **Session 23: Annual Roundtable with the Board of Licensure (Piscataquog Room)**

NHLSA 54th Annual Workshop Schedule

DoubleTree by Hilton Manchester Downtown - Manchester, NH

REGISTRATION: 7:30 AM		December 7, 2023				Assembly Foyer					
Pemigewasset Room	Professional Track	Session 1: Increasing Your Professional Value, Professional Document for Liability Protection, and Becoming a Flood Consultant				8:00 AM - 4:00 PM					
Contoocook & Merrimack	Tech Track	Session 2: PLSS Breakdown; Single and Double Proportioning; Horizontal Curves; Vertical Curves				8:00 AM - 4:00 PM					
Sign-in/out to receive continuing education units (1/4 ceu will be awarded for each hour session attended) (must attend entire session to receive full credit)											
REGISTRATION: 7:30 AM		December 8, 2023				Assembly Foyer					
TIMES						Piscataquog					
7:30 AM 12:00-2:00 PM	Continental Breakfast, Breaks & Lunch in Armory					Past Presidents Breakfast 7:30 - 9:00					
8:00 AM 4:00 PM	Equipment Show in Armory										
TIMES	Pemigewasset	Frost	Dartmouth	Contoocook	Merrimack						
8:00 AM	Session 3: A Case Study: Legal Aspects for Survey Technicians on the Path to Licensure 8:00 - 10:00	Session 4: Registry of Deeds: Protecting the Past 8:00 - 9:00	Session 5: Top 10 Practical Lessons for Being an Effective Land Surveyor in Court 8:00 am - 10:00	Session 6: Update on Grav-D and Progress Toward a New Vertical Datum 8:00 - 10:00	Session 7: Rules of Construction 8:00 - 10:00						
8:30 AM											
9:00 AM									Room clean-up 9:00 - 9:30		
9:30 AM						Session 8: Navigating the NH Shoreland Protection Act 9:00 am - 10:15					
10:00 AM	Break		Break	Break	Break	Session 9: NESS Roundtable 9:30 - 10:30					
10:30 AM	Session 10: Panel Discussion on Business Operations From the Perspective of Sea- soned and Young Professionals 10:15-12:15	Break			Session 14: Best Practices for Using Base/Rover GNSS 10:15 - 11:15	Session 16: New England Women Surveyors Roundtable 10:30 - 12:30					
11:00 AM			Session 11: Railroads in New Hampshire 10:30 - 12:30	Session 12: Micro Topics in Surveying 10:15 - 12:15	Session 13: Surveying Software and Technologies 10:15 - 12:15						
11:30 AM					Session 15: NHDES Subsurface Bureau Leg. Update 11:15 - 12:15						
12:00 PM	Lunch 12:00 - 2:00 Afternoon Break 3:00 - 3:15	Session: 17: Exclusive Viewing Time for Exhibitors -- Don't forget to get your vendor card stamped. If you receive a stamp from every vendor, you will receive 0.5 CEU.									
12:30 PM											
1:00 PM							Thursday AM Break 10:00 - 10:15 Friday AM Break, at the discretion of the presenter				
1:30 PM											
2:00 PM	Session 18: Technical Topics on Civil 3D for the Surveyor 2:00 - 4:00	Session 19: Young Surveyors Roundtable 2:00 - 4:00	Session 20: National Society of Professional Surveyors Certified Survey Technicians (CST) Program 1:00 - 5:00	Session 21: The Zoning Board of Adjustment Strategies for Surveyors and Traps for the Unwary 2:00 - 4:00	Session 22: The Certified Floodplain Surveyor 2:00 - 4:00	Session 23: Annual Roundtable with the Board of Licensure 2:00 - 4:00					
2:30 PM											
3:00 PM											
3:30 PM											
4:00 PM											
4:30 PM											
5:00 PM											
Certificates will be mailed											

SEMINAR ★ THURSDAY, DECEMBER 7th

NHLSA 54th Annual Meeting & Equipment Show

Thursday's Sponsors

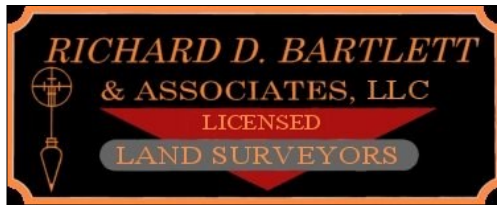

Continental Breakfast

(1) Increasing Your Professional Value; Professional Documents for Liability Protection; and Becoming a Flood Consultant

James D. Nadeau
Nadeau Land Surveys

Increasing Your Professional Value - Determining the appropriate fees for land surveying services requires an organizational belief that such services are both important and unique. This program will share strategies to increase individual and organizational worth, convey competence to a prospective client, and explore ways to create a more profitable business model.

Professional Documents for Liability Protection - Written communication is extremely important in conveying services rendered, but also, services which are not included. Documents that enhance communication, streamline projects, and reduce or eliminate liability will be discussed.

Becoming a Flood Consultant - Most communities across the nation are without consultants to offer guidance, direction and solutions for unexpected flood obstacles. Community officials, lenders, title companies, Realtors, and design consultants benefit greatly from a flood consultant who understands the National Flood Insurance Program, especially insurance rating and mapping changes that affect property owners. Understanding the flood program in more depth will be discussed.

Jim Nadeau has provided land consultation and real estate brokerage services for over 30 years. He is a Professional Land Surveyor, current Chair of the Maine Board of Licensure for Professional Land Surveyors, holds the three National Flood Insurance Program designations, is a member of the Maine Climate Council, and is also a Designated Broker at Jim Nadeau Realty. His experience in diverse fields allows him to provide comprehensive and unique service and education to homeowners, as well as, mortgage, insurance, land use, and design consultants.



8:00 am—4:00 pm
(Pemigewasset Room)

2.0 NH LLS CEUs

Morning Break

(2) PLSS Breakdown; Single and Double Proportioning; Horizontal Curves; Vertical Curves

Dane M. Courville, PLS
State of Colorado Department of Transportation

1 PLSS Breakdown:

The lesson on PLSS breakdown goes through the history, rules, reasoning, and process of the breakdown and survey of public lands states. The process from start to finish is described; from base line/principal meridian, to quadrangles, to townships, to sections. Will focus on history, purpose, timeline, and process of the US survey system layout.

(duration= 1 ½ hour presentation and discussion)

2 Single/Double Proportioning:

The lesson is an in-depth discussion on the procedures used to reestablish sectionalized lands through the mathematics of single and double proportioning. Will focus on when to use proportioning and will simplify the process systematically.

(duration= 2 hour presentation and discussion)

3 Horizontal Curves:

The lesson will target the major features of survey mathematics are breaking down horizontal curves and solving for their different elements. These curves have embedded in them many different aspects of surveying fundamentals that are highly beneficial to learn and understand. This lesson outlines the procedures of solving for the various elements of these curves and displays the calculations in an organized and logical process. Will focus on parts of the curve and the equations to solve them.

(duration= 1 ½ hour presentation and discussion)

4 Vertical Curves:

The lesson will target the major features of survey mathematics are breaking down vertical curves and solving for their different elements. These curves have embedded in them many different aspects of surveying fundamentals that are highly beneficial to learn and understand. This lesson outlines the procedures of solving for the various elements of these curves and displays the calculations in an organized and logical process. Will focus on parts of the curve and the equations to solve them.

(duration= 1 ½ hour presentation and discussion)

SEMINAR & SPECIAL EVENTS ★ THURSDAY, DECEMBER 7th

NHLSA 54th Annual Meeting & Equipment Show

After initial careers in Archaeology and as a Montessori Teacher, **Dane Courville** began surveying in the State of Maine in 2005. On day one, he knew he was a surveyor at heart. The job and all it entails was a perfect fit for him. Dane has worked and lived across the United States; born and raised in Louisiana with moves to Texas, Nevada, Idaho, Maine, and finally Colorado. In Maine in 2005, he found his first surveying employment with Ginn Land Surveying and Plisga and Day Land Surveyors in Bangor, Maine.



With these firms he learned a tremendous amount of surveying knowledge and a skill set that put him on course to becoming licensed. Dane became licensed in the State of Maine in 2007 as a Land Surveyor in Training (LSIT) and finally a Professional Land Surveyor (PLS) in 2009. Leaving Maine led him back to Texas where he gained his Registered Professional Land Surveyor (RPLS) in 2010 with the nation's largest all-surveying firm Surveying and Mapping, LLC (SAM). Dane transferred to Colorado in 2015, and subsequently obtained his professional land surveyor licenses in Vermont, Colorado, and Oregon. In all, he has gained five licenses in both metes and bounds and public lands states and nearly 18 years of survey experience working in many different survey disciplines (e.g., residential, commercial, ALTA, energy sector, transportation, construction, etc.). Dane is currently employed as a regional surveyor supervisor at the Department of Transportation with the State of Colorado. Dane has authored two manuals on surveying and routinely speaks at conferences and training seminars across the country.

Merrimack/Contoocook Rooms 8:00 AM - 4:00 PM



Lunch



Afternoon Break

NHLSA COMMITTEE MEETINGS

I encourage all Committee Chairs to take the opportunity to meet with your committee members for this brief period before the Annual Business Meeting.

Eric Salovitch, LLS
President

Pemigewasset Room 3:30 PM - 4:00 PM

NHLSA ANNUAL BUSINESS MEETING, AWARDS, & INSTALLATION CEREMONY

The New Hampshire Land Surveyors Association is wrapping up the year at our 54th Annual Meeting and Equipment Show. Everyone is invited to attend our Annual Meeting where important agenda topics will be addressed. Business includes an update on the website, and budget review, specifically legislation. We look forward to seeing you all there.

Eric Salovitch, LLS
President

Pemigewasset Room 4:00 PM - 6:00 PM

NHLSA RECEPTION WITH HORS D' OEUVRES, CASH BAR, NHLSF LIVE BENEFIT AUCTION AND RAFFLE

At our annual business meeting, we'll install the officers for 2024. If elected, I will be your new President for our 55th year and I invite you to join me for our evening activities. Our reception, with hors d'oeuvres and cash bar, will again feature our 50/50 raffle. Craig Bailey, Vice President, and I will be canvassing the conference, selling tickets throughout Thursday and Friday until noon. The final drawing will be on Friday! If you don't see Craig or me, 50/50 tickets will also be available at the registration table throughout both days. Remember, the winning ticket will be drawn Friday during the afternoon break.

50/50

While mingling with colleagues, and hopefully not spent all of your money on raffle tickets and saved some for the possible bidding wars of the NHLSF Live Auction. Terry Eldredge is planning to join us and continue his lively and fun hosting duties, with the assistance of our generous volunteers.

Ryan Fowler, LLS
President-Elect

Assembly 6:00 PM - 7:00 PM



Reception

SPECIAL EVENTS

NHLSA 54th Annual Meeting & Equipment Show

NHLSA AWARDS BANQUET

I invite you to join me for the Awards Banquet, enjoy a good meal, continued conversation with friends, or someone you have yet to meet, and the fun will continue when the LIVE BAND starts. They will begin while we're in the buffet line, background music during dinner, and once dinner is complete, we hope you'll get up on the dance floor and show us your moves.

The New Hampshire Land Surveyors Foundation is accepting donations, small, large, or in between. This year, the proceeds will benefit the Scholarship Fund. We can always expect a wide variety of items that will interest all banquet attendees, members, and guests alike. If you have any items that you would like to donate to the auction, please fill out the enclosed auction form and email it to Barbara ahead of time or drop it off with the item at the registration desk.

As for the winning Map Contest entries, don't forget to stop by the registration table to claim your drink ticket!



We will end the evening with a door prize. Members who register for two days will receive a ticket during registration, and you must be present to win.

Since the 50/50 raffle extends through two days, you need not be present to win, just write your name on the ticket you drop in the provided fishbowl. The winning ticket holder will receive half of the proceeds with the remaining half donated to the Robert G. Moynihan Education Fund.

Craig Bailey, LLS, PE, PSM
Vice President

Three Rivers **7:00 PM - 9:00 PM**
Piscataquog, Merrimack, Contoocook



The Silent Auction will open during lunchtime on Thursday and close following the Friday afternoon break. When you recycle your badge at the end of the day, check out the list of lucky recipients. If you can't stay for the entire event, please consider making arrangements for picking up your winning item.

If you have an item for the auction but will not be able to attend, please contact Barbara Cormier or Craig Bailey and they will make sure it gets on the auction block.

Thursday December 7 - Friday, December 8, 2023



Please join us as we welcome our evening entertainment, Dancing Madly Backwards.

Dancing Madly Backwards was founded in 2011 by Lou Goodwin (bass, vocals), Lewis Goodwin (guitar, saxophone, vocals), and Michael Seavey (guitar, keyboard, harmonica, vocals) as an acoustic trio subgroup of the New England classic rock band, Brothers In Arms. Just a few days before Christmas in December of 2012, DMB recruited drummer Avery Stuart to fill out their rhythm section.

Later that month, they began work on their self-titled album. After successfully releasing their first album in August of 2013, the group immediately began work on their second album. The second album, String 'n Things, was released in August of 2014.

The summer of 2015 was a transitional period for the band. Midway through the summer, after working through some creative differences, the band decided to part ways with member Michael Seavey. Needing to fill the void left by Seavey, the band contacted long-time friend and musician Nathan Mann. Mann (guitar, keyboard, vocals) had filled in on drums for Stuart several times in the years prior, and was familiar with the band's music, which helped the transition to go very smoothly.

Dancing Madly Backwards is currently working on music for their next album, while still playing shows every week and remaining very active in the local music community.

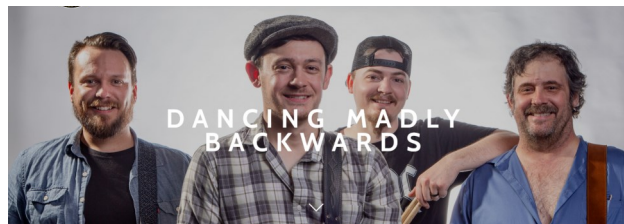

Feel free to visit their website to listen to their sounds and where they draw their inspiration from.
<http://www.dancingmadlybackwardsband.com/>

Schedule Subject to Change -
Updates will be emailed, along with reminders of upcoming deadlines.

PAST PRESIDENTS ASSEMBLY ★ WORKSHOPS ★ FRIDAY, DECEMBER 8th

NHLSA 54th Annual Meeting & Equipment Show

Friday's Sponsors



Past Presidents Breakfast

PAST PRESIDENTS BREAKFAST

Eric Salovitch, incoming Chair, welcomes all Past Presidents to assemble and partake in the discussion on the following topics:

- ◆ Elect a taker of minutes
- ◆ Report on discretionary fund
- ◆ NSPS News and Views and related benefits of membership
- ◆ Brief discussion on young surveyors groups across the New England region

Please contact President Salovitch prior to December 1st regarding any other topics for discussion at the breakfast.

Piscataquog Room

7:30 AM - 9:00 AM



Continental Breakfast

Remember to sign in/out for each session to receive continuing education units (1/4 CEU for each hour session attended). Attendees must attend entire session to receive full credit.

(3) A Case Study: Legal Aspects for Survey Technicians on the Path to Licensure

Mike Hammer
VHB Inc.

Family land, modern subdivisions, an ancient road, and Interstate Highway, and act of Town Selectmen, and a Commitment for Title Insurance serve as an introduction to several aspects of law for aspiring survey technicians and paraprofessionals. The format of this seminar is discussion, question, and answer.

Mike Hammer, LLS PLS (NH, MS, VT) is a Senior Geomatics Project Manager with VHB Bedford and former adjunct faculty at Wentworth Institute of Technology. He has worked on boundary, land development, and public infrastructure throughout the Northeast.

8:00 AM - 10:00 AM
Pemigewasset Room

0.50 NH LLS CEUs

(4) Protecting the Past, Processing the Present, and Preparing for the Future

Kelley Monahan, Register/President
Grafton County

Kelley Monahan's first love is soil science and farming, but planning is a close second. Owning a small farm in the zoning free town of Orford for 25 years, has provided a wealth of experiences. Her service to the Town Planning Board, combined with her many years of technology integration, project and staff management, led her to run for office as the Grafton County Register of Deeds, an office that she has held for 12 years. She has represented New Hampshire at national conferences as a member of PRIA, Property Records Industry Association and has served as Secretary, Vice President and is currently serving as President of the NH Register of Deeds Association.

Kelley Monahan worked with NHLSA on a Zoom meeting last fall, and helped organize a "Learn at Lunch" in conjunction with NHLSA and NH Office of Strategic Initiatives last December, to identify mutual concerns and provide an open dialogue on joint problem solving.



She will be speaking on emerging issues of concern to all stakeholders to help communicate the challenges the registers face on the other side of the counter.

8:00 AM - 9:00 AM
Frost Room

0.25 NH LLS CEUs



Morning Break

WORKSHOPS ★ FRIDAY, DECEMBER 8th

NHLSA 54th Annual Meeting & Equipment Show

(5) Top 10 Practical Lessons for Being an Effective Land Surveyor in Court

A. Richard Vannozzi

We've all heard about and read about being deposed and testifying in open court. Many of us have had an "opportunity" to do these things. For some it is just like another day at work, for others it is something they live in fear of. Sometimes it is to defend our own work, sometimes it is to opine about an issue being litigated for which a surveyor's opinion is needed. Reading all the books and articles in the world on this subject might be nice...but it is the presenter's opinion that there are just a few key concepts and rules that one must understand and follow, so your day in court doesn't end like Jack Nicholson's in "A Few Good Men".

Mr. Vannozzi is a graduate of the University of Maine where, in 1984, he earned a BS in Forestry and, in 2006, earned an MS in Forestry, both with a surveying emphasis.



Mr. Vannozzi has taught surveying across New England since 2003. Currently, Mr. Vannozzi is on the faculty of the Surveying Engineering Technology program at The University of Maine where he teaches courses across the curriculum both in the traditional classroom and on-line.

He is registered as a Professional Land Surveyor in Massachusetts and has been since 1988 at the age of 25. He is a Past-President of the Massachusetts Association of Land Surveyors and Civil Engineers (MALSCE) and, in 1998, was recognized as MALSCE's Surveyor of the Year. Mr. Vannozzi was the 2012 recipient of ACSM's Earle J. Fennell Award for distinguished educational contributions to ACSM and the surveying and mapping profession. Mr. Vannozzi represented Massachusetts on the NSPS Board of Directors (and its precursor, the NSPS Board of Governors) from 2008 through 2019, twice being chosen as the Key Director at the bi-annual meetings. In 2017, Mr. Vannozzi was elected a Fellow of NSPS. He currently serves on the NSPS Education Committee and is the advisor to the NSPS Student Chapter at the University of Maine.

Mr. Vannozzi maintains a small consulting practice that specializes in complex boundary, title, and zoning matters for selecting clients including attorneys and other Professional Land Surveyors.

8:00 AM - 10:00 AM **0.50 NH LLS CEUs**
Dartmouth Room

(6) Update on Grav-D and Progress Toward a New Geopotential Datum

Dan Martin, LS National Geodetic Survey

Update on GRAV-D and progress toward a new geopotential datum [The National Geodetic Survey \(NGS\) has a clearly stated mission](#) to "define, maintain and provide access to the National Spatial Reference System" (NSRS). Accurate gravity data is the foundation for the Federal government's determination of

heights (the vertical component of the NSRS). In this presentation we will discuss the purpose and progress of the ongoing GRAV-D Project (Gravity for the Redefinition of the American Vertical Datum) and highlight other activities contributing toward the creation of a new geopotential datum which will replace NAVD 88.

Dan Martin has worked for the National Geodetic Survey since 2003, and has been the Northeast Regional Geodetic Advisor since 2015. As the Regional Advisor, he instructs local surveyors, state and municipal agencies, and the geospatial community at large, on how to use and preserve the National Spatial Reference System, and provides liaison between the National Geodetic Survey and the States of ME, NH, VT, MA, CT, RI, NY, and NJ, as well as other federal agencies. Prior to that he worked in the Route Survey and Geodetic Survey sections of the Vermont Agency of Transportation from 1988 through 2003, and held the position of Geodetic Program Supervisor for the Agency from 1999 through 2003. Dan is a Past President and Fellow Member of the American Association for Geodetic Surveying (AAGS), an Honorary Member of the Vermont Society of Land Surveyors and a member of the New Hampshire Land Surveyors Association.



8:00 AM - 10:00 AM **0.50 NH LLS CEUs**
Contoocook Room

(7) Rules of Construction

Dane M. Courville, PLS State of Colorado Department of Transportation

The lesson will be a discussion of the hierarchy and precedence of the rules of construction. Will focus on 1) intent, 2) original location, 3) monuments, 4) measurements, and 5) area and will dive deep on the purpose and each aspect of the rules of construction hierarchy.

See Bio on page 6.

8:00 AM - 10:00 AM **0.50 NH LLS CEUs**
Merrimack Room

(8) Navigating the NH Shoreland Protection Act and Recognizing Common Pitfalls

Jay Aube TFMoran, Inc.

As the former Shoreland Program Outreach Coordinator for the NH Department of Environmental Services (NHDES) Shoreland Program, Jay has twelve years of experience in the public sector. His experience at NHDES also includes Wetlands and Shoreland permitting as well as the enforcement of NH Alteration of Terrain Law, the NH Shoreland Water Quality Protection Act (SWQPA) and NH Wetlands Law. Today, Jay is Project Manager and Environmental Permitting Specialist for TFMoran, Inc.

See page 16 for DES sessions.

WORKSHOPS ★ FRIDAY, DECEMBER 8th

NHLSA 54th Annual Meeting & Equipment Show

Jay Aube received his Bachelor of Science in Environmental Biology, with a minor in Chemistry, from Plymouth State University and Jay is a NH Certified Wetlands Scientist (CWS). Jay serves as a member of the City of Dover Conservation Commission, and he is the Vice Chair of the Cocheco River Local Advisory Committee. Jay is also a member of the NH Association of Natural Resource Scientists (NHANRS). During his free time, you can find Jay skiing, hiking, biking or sea kayaking.



9:00 AM - 10:15 AM
Frost Room

0.25 NH LLS CEUs

(9) North East Surveying Societies (NESS) Roundtable

Ryan Fowler, LLS #1054
Moderator

Join me and other North East State Presidents for an informal NESS meeting to continue our ongoing dialogue and initiatives. Regional issues such as metrics on membership and young surveyor groups are key to the success of all state societies and NSPS.



We'll discuss the challenges we've overcome during the last few years, and how we have been integrating hybrid participation as remote participation, clearly creates value to our memberships. In addition, we'll touch on recent efforts to introduce additional educational opportunities to the New England area, including the addition of our Technician Track at our Annual meeting and future meetings.

Please feel free to contact me prior to the meeting at ryanmcfowler@gmail.com.

9:30 AM - 10:30 AM
Piscataquog Room

0.25 NH LLS CEUs

(10) Panel Discussion on Business Operations from the Perspective of Seasoned and Young Professionals

Craig Bailey
Moderator

Panelists: Roy Sabourn, Eric Salovich, Clayton Platt, Eric Peabody

The following questions should help spur a lively discussion on business practices, methods, and lessons learned – all geared towards improving members' own surveying practices.

Warm up questions:

1. When and where did you start surveying?
2. Preference of a Big office? Or Small office? And why?
3. How soon did you know you were interested in running / opening your own shop?

Let's talk about some basic business:

1. What's your thoughts on business types:
 - a. Sole Proprietorship
 - b. Partnership
 - c. LLC
 - d. PLLC
 - e. Incorporated
2. Let's talk about contract types:
 - a. Written Proposal?
 - b. Written "Quote"?
 - c. Written Estimate?
 - d. Handshakes?
3. How do you handle subcontractors?
4. What's your thoughts on Proprietary information / data?
5. What about insurance?
 - a. General Liability? Is it needed?
 - b. Errors and Omissions?

Office operations

1. Who "runs" your office?
2. Who answers the phone?
3. Who sends the bills?
4. How long is too long to wait to send a bill?

Billing Practices:

1. Let's talk about billing practices:
 - a. Fixed fee
 - b. Estimates
 - c. Not to exceed
2. How long is too long to wait to send a bill?
3. What is the "best" type of bookkeeping method:
 - a. Software like Quick Books
 - b. A spreadsheet
 - c. Something in between?
4. What are your thoughts on Overhead?
 - a. How much overhead is too much?
 - b. How do you track overhead?
5. What about profits?
 - a. This shouldn't be a taboo subject – this isn't a hobby.
 - b. How do you track profit?
 - c. What do you do to minimize your tax exposure?

Professional billing rates:

1. What does it mean to you when someone uses the slang term "We're in a race to the bottom!"
2. What are your thoughts regarding the concept that the services a land surveyor provides are sometimes considered unappreciated? Is there anything the industry could do from a business standpoint to combat this?

Roy A. Sabourn, NHLLS 619 has been surveying since 1974, and started his own business in 1983. He sold the business to Stephen Tower in 2013, now DBA Sabourn & Tower Surveying and Septic Design, PLLC. Roy is still employed on a part time, as needed basis, primarily performing research, drafting reports and plan checking. When not working for Steve, Roy can generally be found working around his home farm and wood lots in Thornton Gore.



WORKSHOPS ★ FRIDAY, DECEMBER 8th

NHLSA 54th Annual Meeting & Equipment Show

Eric Salovitch graduated from the University of New Hampshire with a Surveying and Mapping Civil Technology Degree in 2010. He is the President and CEO of Northam Survey, LLC established in 2021.



He is a Licensed Land Surveyor in New Hampshire and Maine. Eric is the former Chair and co-founder of the New Hampshire Young Surveyors Committee. Eric is active within the NSPS Young Surveyors Network participating in forums and virtual discussions on promoting the surveying profession. Eric makes yearly visits to several local high schools introducing the profession to the next generation, sometimes administering the Trig-Star exam. Outside of work, Eric can be found at the local Crossfit gym, swimming, biking, or running New Hampshire's Seacoast. Eric lives in Dover with his wife Caitlin and dog Winston.

Clayton Platt graduated from UNH with a forestry degree in 1985. He worked for many years splitting his time between forestry consulting and land surveying in the Lake Sunapee area. In 1996 he started Pennyroyal Hill Land Surveying and Forestry LLC. Over the years the very small company fluctuated from two full-time employees to one part-time assistant. Business growth was never a high priority. He concentrated on maintaining a steady amount of work for the local community- following in the footsteps of the small-town surveyors that came before him. As survey work became more available and forestry work more complicated, he now spends almost all his work life on land surveying.

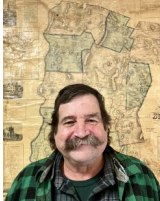

Eric Peabody fell into land surveying in the spring of 2006 after responding to an ad in the local paper. After a summer trudging through the woods on a field crew, he was hooked. In 2008, he graduated from White Mountains Community College with an A.S. in Surveying Technology and spent many years working multiple aspects of the profession throughout the Upper Valley. Eric is licensed in NH and VT and is the owner of Green Top Land Surveying, LLC. He serves as a member of the City of Claremont Conservation Commission. In his free time, he can be found spending time with his family and building and tinkering on projects around the house.



10:15 AM - 12:15 PM **0.50 NH LLS CEUs**
Pemigewasset Room

(11) Railroads in New Hampshire

Joshua Prescott
NH Department of Transportation

Rail lines in the state of NH, owners, and operators. Safety around Rail Right of ways, NH Granit geodetic control and program Railroad Trespass.

Joshua Prescott has worked for the New Hampshire Department of Transportation for 22 years, two years in the Bureau of Highway Design, Survey section, 18 years in the Highway Design, Design Services section as railroad coordinator, and two years in the Bureau of Rail and Transit as railroad coordinator.



10:30 AM - 12:30 PM **0.50 NH LLS CEUs**
Frost Room

(12) Micro Topics in Surveying

Edward L. Rogers, PE, LLS
Rogers Engineering Solutions, LLC

Ed will attempt to segue seamlessly between various surveying topics including: Where will the next generation of surveyors come from? How do we document what we find, and what we didn't find? Is the Pythagorean Theorem true? How do you know? Where does it come from? Did you know the world's funniest joke is a trigonometry joke? What is the rule of 70 and how can it help you run your business more effectively? Have you ever played six degrees of Joseph Blanchard?

Edward L. Rogers, PE, LLS has been involved in surveying for the last 29 years and started Rogers Engineering Solutions, LLC in 2005. His experience on Boston's Big Dig provided him with a unique perspective on roads, surveying, and the 4-dimensional puzzles they represent. For the past 20 years he has focused on surveying and engineering projects in New Hampshire, taking some detours along the way including teaching high school trigonometry and serving as a member of the Housing Appeals Board. Ed's past presentations include "NH Road Research Part I", "Turnpikes and County Roads", and a case study of Green Crow vs. the Town of New Ipswich, NH.



10:15 AM - 12:15 PM **0.50 NH LLS CEUs**
Dartmouth Room

(13) Surveying Software and Technologies

Rick Ladd—CADNET Services, LLP
Todd Carlson—Carlson Software

Check out some new software and technology for use in your surveying and engineering business. Presented by Rick Ladd and Todd Carlson.

Rick Ladd is President of CADNET Services, LLP, a single source provider of CAD, CAD training, and IT solutions. With over 25 years of experience in CAD systems and engineering, Rick has become an industry resource on latest trends in surveying system technology. Rick was an Adjunct Faculty member with the University of NH for 12 years, where



WORKSHOPS ★ FRIDAY, DECEMBER 8th

NHLSA 54th Annual Meeting & Equipment Show

worked as a CAD instructor for Civil Engineering students; today he offers the same field-tested expertise in virtual training at cadnetservices.com. Connect with Rick on LinkedIn.

Todd Carlson is the Director of Marketing and New England Sales Manager for Carlson Software, working out of Carlson's main development office in Watertown, MA. Prior to his current role, Todd worked in technical support, training, and product development for the construction estimating and data prep package Carlson Takeoff.



Rick Ladd—CADNET Services, LLP
Todd Carlson—Carlson Software

10:15 AM - 12:15 PM
Contoocook Room

0.50 NH LLS CEUs

(14) How to Choose the Right GNSS Tools for the Greatest Productivity

Harry Schultz
Waypoint Technology Group

We will begin this presentation by reviewing some fundamentals of as well as recent improvements to GNSS Technology. Next, we will examine how different projects may require different approaches based on various factors including budget, precision requirements, sky-view, and other considerations. The remaining portion of this course will be spent reviewing some of the software tools that are available for processing your GNSS data, QA/QC, and export options.

- I. Introduction & Course description
- II. Review the fundamentals of Differential Correction
 - A. GNSS 101
 - i. Trilateration NOT Triangulation
 - ii. Real Time or Postprocessed?
 - iii. Advantages of working in Real Time
- III. The evolution of GNSS
 - A. Current Constellations
 - B. Satellites & Signals
 - C. How receivers are utilizing these signals today
- IV. Different ways to use GNSS & when
 - A. GNSS survey styles Pros & Cons
 - B. Project specific considerations
- V. QA & QC tools to review your GNSS data before export
 - A. Tolerances
 - B. Selection tools
 - C. Reporting
 - D. Adjustments
- VI. Questions & Answers

Harry Schultz is the Vice President of Waypoint Technology Group where he has worked for the past fourteen years. He is a licensed Professional Land Surveyor with over 25 years of experience using Trimble technology for high-accuracy data collection. He is also certified by Trimble to provide professional training for all of the Geospatial hardware and software solutions. At Waypoint Technology Group, Mr. Shultz leads the survey sales team while also providing customized training, support, and consultation services to their customers. Harry received his AAS in Land Surveying

from Paul Smith's college in the Adirondack mountains of NY. Prior to Waypoint Technology Group, he worked for a large Survey/Engineering firm where he worked as a land surveyor on projects all over the Northeastern portion of the United States.

10:15 AM - 11:15 AM
Merrimack Room

0.25 NH LLS CEUs

(15) NHDES Subsurface Bureau Legislation Update

David Aiton
NH DES Subsurface Bureau

An overview of recently passed legislation relating to the NHDES Subsurface Bureau. Additional topics include upcoming law and rule changes and additional topics related to NHDES septic system and subdivision applications.

David Aiton has been working in the civil engineering field since 2004. Prior to his roles as a regional inspector and outreach specialist with NHDES, he worked for over 18 years as a civil engineering technician for a survey and engineering company in the Lakes Region.

11:15 AM - 12:15 PM
Merrimack Room

0.25 NH LLS CEUs

(16) NEWS—New England Women Surveyors Roundtable

Cynthia Boisvert, LLS
Wendy Pelletier, LLS
Moderators

Join us as we discuss topics relevant to being a woman in a predominantly male field. This is a group that was formed four years ago in the hopes of getting more of us together in one place from NH and other New England states. We would like to set some goals this year and formalize a mission for our group, and discuss becoming involved in STEM schools, focusing on introducing young women to our profession.

Cynthia Boisvert has been a NH Licensed Land Surveyor for 37 years, beginning her survey career in North Conway, NH, working for HEB Engineers and Burnell Land Surveying. Since 1980, she has been working in southern NH. Six years as VP of Survey Services at Cuoco & Cormier, Inc. and currently as President of Arago Land Consulting, LLC, located in Amherst NH. Cynthia has served the NH Land Surveyors Association, as Vice President, President Elect, President, Past President, and Publications Director, and is currently the Registry of Deeds Liaison. She has a BS in Environmental Design from the University of Massachusetts, Amherst.



Wendy Pelletier has been in the surveying field since 1984 when she worked for the City of Auburn, Maine during her first summer off from college. After being in the field for a week on the survey crew, doing topo of a landfill of all



WORKSHOPS ★ FRIDAY, DECEMBER 8th

NHLSA 54th Annual Meeting & Equipment Show

things, she decided to change her major from Architecture to Civil Engineering. She graduated from Vermont Technical College with an Associate's Degree in Civil Engineering Technology in 1986. She went on to work in septic design in Shelburne, Vermont before moving to Keene, New Hampshire to work for C.T. Male Associates. Wendy moved back to Maine to work in engineering for 6 years before coming back to Keene. Wendy worked for David Mann and Richard Drew while preparing for the SIT and licensing exams. She became licensed in 2009. She is currently the President and owner of Cardinal Surveying & Land Planning in Keene. Wendy has been the Treasurer of NHLSA since 2014.

10:30 PM - 12:30 PM
Piscataquog Room

0.50 NH LLS CEUs



Lunch

(17) Exclusive Viewing of Exhibit Hall

This is a great opportunity to see some of the latest products and services the vendors have to offer. You will have the opportunity to see demonstrations, ask questions and perhaps make a purchase or two. You just may find that key piece of information, a helpful hint, or some new equipment that you were looking for to help you out with that tough project back at the office.

If you make a point to stop by each booth, the vendors will stamp your vendor card provided at sign in, and you will receive the 0.5 CEU credit for your time spent. See page 18 for a list of reserved exhibitors.

12:00 PM - 2:00 PM
Armory

0.50 NH LLS CEUs

(18) Technical Topics on Civil 3D for the Surveyor

Craig T. Bailey, LLS
Bryan L. Bailey Associates, Inc.

Do you use Civil 3D for surveying tasks? Do you have the most efficient template or settings possible? Don't you wish there was a place where we could share ideas and dig a little deeper into style development, or settings management? Look no further! This session will tackle some of the best practices that a surveyor might consider. We will develop some labels that actually use expressions. We will develop

some work flows on how to process a set of field notes using Least Squares. We can review some of the deeper field to finish issues that we encounter. This will not be an introductory look at Civil 3D – but rather an **intermediate to advanced** look at a handful of topics geared towards a practicing Surveyor. Bring your questions. Bring your template if you want! Bring some field notes even, and we can use these real-world examples for workflow improvement.

CRAIG T. BAILEY, LLS A second generation land surveyor, Craig holds degrees from UNH and the University of Maine, is a PE, and a certified NH Septic Designer. Craig has been working professionally in the land development industry since 1999, plus high school summers. Craig has served on the Faculty at NHTI as an Adjunct professor for the Civil Engineering Technology & Architectural Technology programs. Hobbies include ham radio, where Craig (N1SFT) is active in the local club, and has a lifelong love of snowmobiling with his family. Craig currently resides in Hudson with his wife Marcie and their two daughters Olivia and Elizabeth.



2:00 PM - 4:00 PM
Pemigewasset Room

0.50 NH LLS CEUs

(19) Young Surveyors Roundtable

Emily Hayes
Stefan Wollmar
Young Surveyors Committee

Please join your fellow Young Surveyors as we review our accomplishments from this past year, discuss ideas for the future and cover an array of on-going topics. We will review the recent changes made to the Certified Survey Technician (CST) program and exams, discuss our continued involvement in the national Young Surveyors Network, and finalize details regarding our study groups for technicians looking to obtain either their preferred certification or licensure. Come prepared to share ideas and advice or just listen in on what is always an interesting assembly.

Emily Hayes graduated from the Thompson School of Applied Science in 2003 and is currently employed at the NH Division of Forests & Lands performing survey projects and boundary line maintenance for state forests & parks. During her spare time, she enjoys hiking & kayaking. She joined the Young Surveyors Committee in 2019 and is looking forward to strengthening the group's student outreach and getting the profession of land surveying into the minds of as many middle & high school students as possible.



2:00 PM - 4:00 PM
Frost Room

0.50 NH LLS CEUs

WORKSHOPS ★ FRIDAY, DECEMBER 8th

NHLSA 54th Annual Meeting & Equipment Show

(20) National Society of Professional Surveyors Certified Survey Technicians (CST) Program

Scott Boudreau, LLS
Proctor

The NSPS CST (Certified Survey Technician) program is a **national certification program** for Survey Technicians (based on experience and examination for field and office) at four levels (Level I; entry level, Level II; instrument/computer operator, Level III; party chief/ chief computer operator, and Level IV; chief of parties/ office manager). It is sponsored by the National Society of Professional Surveyors. The Certified Survey Technician Board (CST Board) administers the program, which is intended to gauge technical capabilities and general knowledge of workplace safety and procedures. Four levels of certification are offered in two primary tracks – field, and office.

The CST program is a way to help our technicians advance in their careers. The testing allows for confirmation of abilities, provides additional education, potential career advancement, and a greater sense of well-being and contribution. We need to encourage our technicians to expand their skill sets and advance in the profession. The CST program is a way to accomplish some of these goals. I would encourage all employers to support their technicians in this career advancement. The CST Program is sponsored by the Association through the R.G. Moynihan Education Fund grant program. The Fund will provide 50% of the cost of the examination to technicians who successfully complete testing at any CST Level, any time they test.

Check in: 12:30 PM, Go to <https://cstnsps.com/apply-online/> to apply. The deadline for this test cycle is November 30th.

The additional education and preparation that the CST program offers can be of great benefit to survey technicians, NHLSA, its members, and future members, by insuring a well-trained work force. In addition, the CST testing program helps to prepare technicians who are looking to track into licensure with exam practice and material competency.

The CST Exam will be proctored by **Scott Boudreau, LLS**. Scott is the owner of Boudreau Land Surveying in Newmarket, NH. He is also a Senior Lecturer at the University of New Hampshire in the Department of Civil and Environmental Engineering, where he teaches Introduction to AutoCAD, GIS for Civil & Environmental Engineering, and Introduction to Surveying".

1:00 PM - 5:00 PM

Dartmouth Room



(21) The Zoning Board of Adjustment: Strategies for Surveyors and Traps for the Unwary

Brett Allard
Shaughnessy Allard

Surveyors frequently represent landowners and other interested parties before the Zoning Board of Adjustment and are now authorized by statute to provide representation before the Housing Appeals Board. This seminar will discuss strategies for surveyors appearing before zoning boards to maximize their effectiveness, from pre-application staff meetings and procedure, preparation and submission of applications, public hearing procedure and presentation tips, and post-hearing appeals. This seminar will also identify common traps and missteps to avoid in the world of increasingly complex real estate development statutes, regulations, and permitting procedures so that your clients are putting their strongest case forward from day one through its conclusion.

Since graduating from the University of New Hampshire School of Law as a member of the Daniel Webster Scholar Honors Program, **Brett Allard** has focused his practice on real estate and land use law. Brett advises clients in all aspects of land planning, zoning, and real estate development matters, helping them navigate through the maze of local, state, and federal permitting. He is well-versed in handling all types of development projects, from basic lot line adjustments to large complex residential subdivisions, commercial projects, mixed use planned unit developments, and roadway issues. Brett previously worked with the New Hampshire Department of Environmental Services Wetlands Bureau and has extensive experience representing clients in lakefront and shoreland development projects. Brett also assists clients in landlord tenant matters and residential and commercial transactions, including acquisitions, dispositions, leasing, and financing. When Brett isn't working, he enjoys spending his free time playing golf, hockey, snowboarding, and traveling.



2:00 PM - 4:00 PM
Contoocook Room

0.50 NH LLS CEUs



Afternoon Break

WORKSHOPS ★ FRIDAY, DECEMBER 8th

NHLA 54th Annual Meeting & Equipment Show

(22) The Certified Floodplain Surveyor Program— What is it and Why is it needed?

Mark Condodemetraky, LLS, PE
G.C. Engineering, Inc.

A history of the NFIP and the CFS program as well as its regulations regarding the need for surveyors and engineers and why the designation is relevant today. Have you ever been in a position to have to answer questions about floods or FEMA or the NFIP, and been at a loss? Is this knowledge really needed in the surveying community? Surveying has been closely tied to FEMA and the NFIP since their inception. As regulations regarding floods become more common in community based zoning, the surveyor will need to understand these regulations and how to navigate them. This workshop will go over the CFS designation and why it is important for Surveyors to earn this certification through NSPS.

Mark Condodemetraky, LLS, PE has been consulting for property owners and communities in the National Flood Insurance Program since 1994, and formerly served on the board of directors of the National Flood Association (NFA). A Licensed PE in ME, NH and VT and a Licensed Surveyor in NH and MA, Mark Lives in the Lakes Region with his wife Andrea and their children.



2:00 PM - 4:00 PM
Merrimack Room

0.50 NH LLS CEUs

(23) NH Board of Licensure for Land Surveyors

Joseph Wichert, Chairman
Michael Dahlberg, Vice-Chairman
Timothy Peloquin, Member

The Board of Licensure will give a presentation about some of the state and national issues in surveying that have occurred in the last year. Topics will include Legislative Action to merge the Surveying Board of Licensure with the Engineering Board of Licensure; eliminate the need for licensure for other associated professions; new changes at OPLC, and the status of the proposed reconfiguration of the national survey licensing exam. The remainder of the session will be dedicated to answering questions from those in attendance. The session will be moderated by Mike Hammer, member of the Education Committee.

As was done last year, members are encouraged to submit questions beforehand to allow the Board time to research answers, if needed. Pre-submission is not required and all questions are welcome.

Joe Wichert has been a Licensed Land Surveyor in NH since 1990 and is the current Chairman of the Board of Land Surveyors. He graduated from the Thompson School of Applied Science at the

University of New Hampshire with an AAS in Construction Technology. He was the past chairman of the NHLA Alternative Dispute Resolution Committee. He was appointed to the Board of Licensure in 2015, was elected vice chairman in 2020 and chairman earlier this year. Joe was also a member of the National Council of Examiners for Engineering and Surveying Examinations for Professional Surveyors (NCEES EPS) committee from 2020 to 2023 and was recently appointed to serve on the newly formed Surveying and Mapping Sciences Licensure Task Force.

Mr. Dahlberg is a licensed land surveyor with over 40 years of experience in New Hampshire, Massachusetts, Maine and Vermont. His passion is historical research, boundary determination and resolution...He has been an Expert Witness for boundary and right-of-way disputes in Northern Middlesex County, MA, Hillsborough, Merrimack and Belknap Counties in N.H. Mr. Dahlberg is responsible for the daily survey operations for TFMoran's Bedford, New Hampshire office.

Timothy A. Peloquin, LLS has been a Licensed Land Surveyor (LLS) in New Hampshire since 1992. He is experienced in all levels of land survey components- historical, land law, research, field work, technology, computation/ CAD/ GIS, management, client/ public relations, etc.; and has a thorough knowledge and use of GPS equipment and associated computations and full integration with CAD (Carlson) and GIS (ESRI). Tim has been the business owner of Promised Land Survey, LLC since February 1998. He was a member of the New Hampshire Land Surveyors Association (NHLA) and Education Director 1995-1997, Executive Committee 2000-2003, and President in 2002. He taught at University of New Hampshire (UNH)/ Thompson School of Applied Sciences Survey II (CT-233) in 1999 & 2006 In July of 2020, Tim was appointed to the New Hampshire Board of Land Surveyors. He served in the United States Coast Guard, Active Duty and Reserve from 1982 to 1992 and received an Honorable Discharge upon completion of his service. Tim and his wife are the Founders of a nonprofit, 501(c)(3) charitable organization, Promised Land Foundation, for their work in impoverished areas of Africa. Last and personal, yet deemed pertinent, Tim is happily married 36 plus years, has 2 great children, is active in the community and church, loves the outdoors, travel, helping others, etc.

2:00 PM - 4:00 PM
Piscataquog Room

0.50 NH LLS CEUs

Remember to sign in/out for each session to receive continuing education units (1/4 CEU for each hour session attended). Attendees must attend entire session to receive full credit.

Thank you
for
attending!

DEPARTMENT OF ENVIRONMENTAL SERVICES ★ 2024 GOALS MEETING

NHLSA 54th Annual Meeting & Equipment Show

DEPARTMENT OF ENVIRONMENTAL SERVICES

DES has approved credits for the following sessions, for septic designers & installers.

Sessions **XXXXXXX**
One (1) credit hour = seat time (length of workshop)

Reminder: Permitted Sewage Disposal System Designers & Installers and Natural Scientists—to receive credit, you must note your license number on the sign in/out sheets.

Dawn Buker no longer requires that she sign your certificate. To receive credit, send her a copy of your NHLSA signed certificate.

Note: Natural Scientists credits are not pre-approved, use your best judgement when choosing your sessions.

NHLSA GOALS & COMMITTEES



Please consider volunteering to become a chair of a vacant committee and/or join an ongoing committee. There are some committees with only one volunteer, for instance, the website. This committee could definitely use additional minds and hands.

NHLSA wouldn't survive without all the great volunteers.

Unfortunately, we are heading into this year's Annual Meeting without a Vice President candidate.

Location:
To Be Determined
January 13, 2024
9:00 a.m. – 3:00 p.m.

SPONSORS ★ NHLSA BOOKSTORE

NHLSA 54th Annual Meeting & Equipment Show

- ◆ Thursday Continental Breakfast
Richard D. Bartlett & Associates, LLC
- ◆ Thursday Morning Break
New Hampshire Land Consultants, PLLC
- ◆ Thursday Lunch
Northam Survey, LLC
- ◆ Thursday Afternoon Break
Alfano Law, PLLC
- ◆ Thursday Reception
Maine Technical Source
- ◆ Friday Continental Breakfast
Horizons Engineering, Inc.
- ◆ Friday Morning Break
Keystone Precision Solutions
- ◆ Friday Lunch
Doucet Survey, Inc.
- ◆ Friday Afternoon Break
Stonewall Surveying
- ◆ Past Presidents Breakfast
Haley Ward, Inc.

- ◆ Souvenir Calendar
Penny Royal Hill Land
Surveying & Forestry, LLC

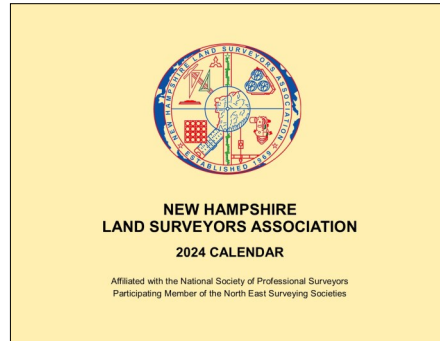

- ◆ Parking for all attendees
Haley Ward, Inc.
- ◆ Wi-Fi for all attendees
James Verra & Associates, Inc.

Thank You
to our Sponsors!

NHLSA BOOKSTORE

Don't forget to stop by the traveling NHLSA Bookstore during the breaks and free time. This is the perfect time to save that 25% shipping & handling charge. Barbara and our devoted volunteers will have a mini bookstore set up in the assembly area and will be selling all of the books and merchandise that you can normally purchase on the NHLSA website. With the end of the year right around the corner, books and reference material may also be good tax deduction business expenses for you, and if you are an aspiring surveyor, some of these books will be invaluable to you in preparing for your exam!



In addition to the reference books, we've also have items like brass discs, lapel pins, and belt buckles. The belt buckles (with proceeds going towards the Scholarship Fund) are numbered sequentially, so if your license number falls between 194-513, you may be able to get a buckle with your license number on it.

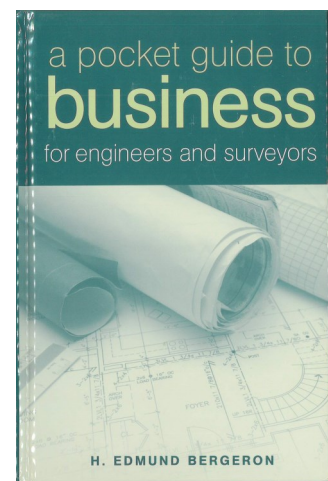

EXHIBITORS

NHLSA 54th Annual Meeting & Equipment Show

ARMORY

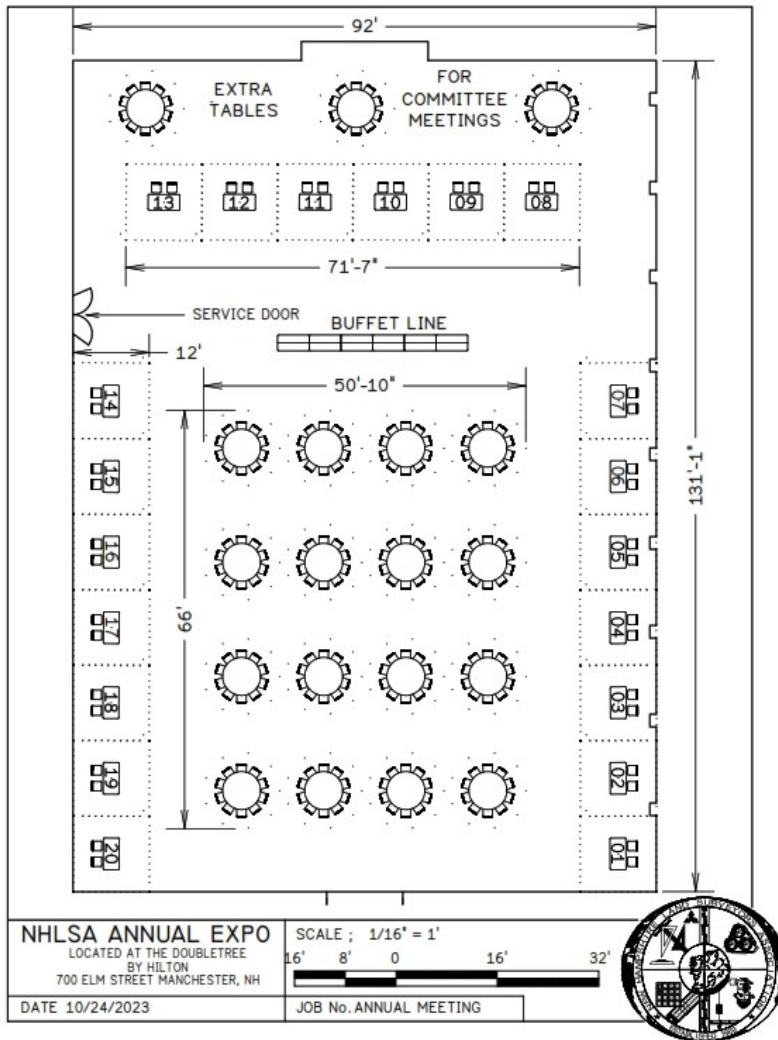

Exhibit Hours Set-Up
Installation
Friday, December 8
6:00 AM - 8:00 AM
Dismantle
Friday, December 8
3:30 PM - 4:00 PM

Thank You
2023 Exhibitors

Exhibit Hall Activity

Continental Breakfast
Friday
7:30 AM

Morning Break
Friday
10:00 AM

Lunch w/Exhibitors

**Session 17:
Exclusive Viewing
of Exhibits**

12:00 PM - 2:00 PM

Afternoon Break
Friday
3:00 PM

Note: Before publication, we were notified that Keystone is unable to attend due to other responsibilities. They apologize for not being there, and do not require a reimbursement. We thank them for their generosity!

Booth: Exhibitor

- | | |
|---|---|
| <ul style="list-style-type: none"> ◆ 1: New England Laser & Transit Company ◆ 2: National Geodetic Survey ◆ 3: National Society of Professional Surveyors ◆ 4: Topcon Solutions Store ◆ 5: Bluesky Geospatial Ltd. ◆ 6: Aerotas, LLC ◆ 7: CADNET Services, LLC ◆ 8: WSP USA ◆ 9: Spiller's | <ul style="list-style-type: none"> ◆ 10 & 11: Waypoint Technology Group ◆ 12: Carlson Software ◆ 13: Keystone Precision Solutions ◆ 14 & 15: Maine Technical Source ◆ 16: Eastern Topographics ◆ 17: Eastpoint Lasers, Inc. ◆ 18: ◆ 19: ◆ 20: |
|---|---|

HOTEL INFORMATION

NHLA 54th Annual Meeting & Equipment Show

The DoubleTree by Hilton Manchester Downtown, 700 Elm Street, Manchester, NH 03101. Phone: 603-206-4216

Room Rate: Single or Double \$159.00; Triple \$169.00 + 8.5% tax/night.

ROOM RESERVATION DEADLINE:

Reservations must be received on or before **November 16, 2023**. At this date, the hotel will review reservation pick up for the event and release the unreserved rooms for general sale.

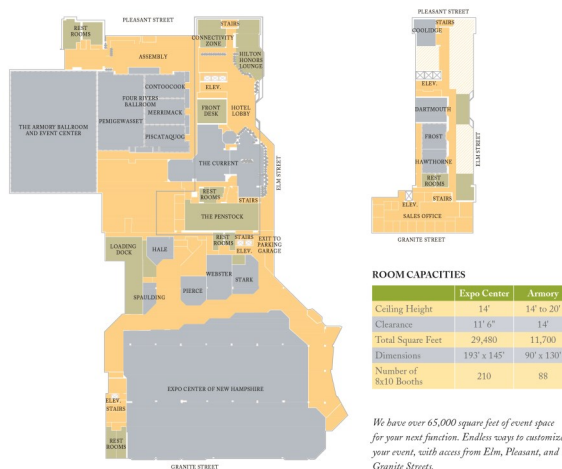

	Expo Center	Armory
Ceiling Height	14'	14' to 20'
Clearance	11' 6"	14'
Total Square Feet	29,480	11,700
Dimensions	193' x 145'	90' x 130'
Number of 8x10 Booths	210	88

We have over 65,000 square feet of event space for your next function. Endless ways to customize your event, with access from Elm, Pleasant, and Granite Streets.

OVERNIGHT RESERVATION OF ROOMS:

1. A block of guestrooms is reserved for use of the NHLA Meeting/Show at group rates.
2. Individuals are responsible for securing their own reservations from this group

Identify yourself as attendees of the NHLA Group in order to receive the discount.

1. Check in is at 3:00 pm and check out is 11:00 am.
2. Cancellation, late arrival or special arrangements should be made directly with the DoubleTree.

Directions to Hotel: The DoubleTree by Hilton Manchester Downtown is located one hour from Boston, the White Mountains, Lakes Region and the Seacoast.

If you need further information, check out the hotel website at: <https://www.hilton.com/en/hotels/mhtmdt-doubletree-manchester-downtown/hotel-location/>

MEETING ROOM CAPACITIES

Room Name	Square Feet	Dimensions	Theater	Classroom	Reception	Round at 10	Ballroom/ Conference	U-Shape
Coolidge	532	19' x 28'	N/A	20	N/A	N/A	14	10
Dartmouth	891	27' x 33'	60	40	60	50	24	16
Frost or Hawthorne	702	27' x 26'	55	30	55	50	21	15
Frost & Hawthorne	1,404	54' x 26'	60	60	100	90	36	25
Four Rivers Ballroom	8,160	96' x 85'	850	500	900	560	N/A	N/A
Benignoisset or Contosook, Merrimack & Piscataog	4,080	85' x 48'	425	250	450	280	N/A	N/A
Contosook, Merrimack or Piscataog	1,344	28' x 48'	125	60	125	80	40	35
Contosook & Merrimack or Merrimack & Piscataog	2,736	57' x 48'	250	125	250	160	75	60
Armory	11,700	90' x 130'	1,200	650	1,200	800	N/A	N/A
Expo Center	29,480	193' x 145'	1,400	1,400	1,400	1,400	N/A	N/A
Stark	938	36' x 26'	75	45	75	70	28	24
Webster	1,115	41' x 36'	120	56	100	90	36	30
Pierce	774	39' x 27'	56	40	60	60	24	20
Hale	644	23' x 28'	50	24	50	50	21	18
Spaulding	420	33' x 13'	32	18	32	20	N/A	N/A

Spouses & Guests

Find us among the shops and restaurants of Elm Street in downtown Manchester. We're a five-minute walk from SNHU Arena, and Manchester-Boston Airport is a five-mile ride on our complimentary shuttle. Enjoy city views from high floors, and a fitness center and indoor pool.

What's nearby:

Currier Museum of Art: 0.8 miles 150 Ash Street
Millyard Museum: 0.2 miles Mill No. 3 200 Bedford Street corner of Commercial and Pleasant Streets
The Palace Theatre: 0.60 miles 80 Hanover Street

Shopping:

Manchester Commons Shopping Center: 401 South Willow Street
The Mall of New Hampshire: 1500 South Willow Street
865 Second Street Shopping Center

Things to do:

Granite State Escape: 0.1 miles 795 Elm Street, Lower Level
Central Ale House: 0.1 miles 23 Central Street
Muse Paintbar: 0.2 miles 42 Hanover Street
The Spa Within: 0 miles
East Colony Fine Art Gallery 0.3 miles 55 So. Commercial Street
St. Joseph's Cathedral 0.5 miles 145 Lowell Street

NHLSF BENEFIT AUCTION ★ THANK YOU FOR YOUR SUPPORT!

NHLSA 54th Annual Meeting & Equipment Show

BENEFIT AUCTION DONATION PLEDGE FORM
Don't miss the Fun, Food and Action at the NHLSA Benefit Auction!
Live Auction Thursday 6:00 - 7:00 PM (during the reception)
Silent Auction ends Friday afternoon (winners announced end of day)

Use this form to make a donation to our Benefit Auction. Please complete the information below and return via fax, email or mail to **NHLSA** Office:603-386-6856; info@nhlsa.org; PO Box 689, Raymond, NH 03077-0689.

Name / Company		Phone ()	
Address		Fax ()	
City	State	Zip	
Item	Fair Market Value \$		

DOOR PRIZE DONATION:

RAFFLE DONATIONS

Please include a brief description of the item (s) to be used by auctioneer. **List additional items on separate piece of paper.**

Small items welcome for mini-raffle, drawing during Friday afternoon break.
 50/50 raffle held throughout both days, closes at 2:00pm Friday, drawing during afternoon break

Please drop off your item and form at the registration table.

Please help in our recordkeeping by using the form below when donating an auction item, door prize, or raffle prize. Thank you for your cooperation and generosity!



Thank you for your Support!!

2023 NHLSA CONVENTION REGISTRATION

*****BEST VALUE*****

NHLSA 54th Annual Meeting & Equipment Show

**Early Bird Full Registration
Before November 6th—\$350/\$200;
If received after the November 20th—
Final Deadline, add \$50**

() () LS () Associate () Affiliate () Student () Non-Member (add \$100 to registration)

Name		Guest Name	
Company		Phone ()	Fax ()
Address		Email Address	
City	State	Zip	Name on Badge

Member* () () NHLSA () CALS () MALSCE () MSLS () RISPLS () VSLS () NYSAPLS
 *Member includes all Northeast State Societies (If member in multiple states, check home state)

#	REGISTRATION	Member	After Nov. 6th	TOTAL
	P.T. Early Bird Full Registration—before Nov. 6 th	\$350.00	\$410.00	\$
	T.T. Early Bird Full Registration—before Nov. 6 th	\$250.00	\$310.00	\$

*****Early Bird—Registration—Tech. Tract through Website Only; Prof. Track must be postmarked by Nov. 6th*****

	Prof. Track Thu Seminar Only (includes meals)		\$250.00	\$
	Tech. Track Thu Seminar Only (includes meals)		\$200.00	\$
	Thu All Day (see below)	\$280.00—P	\$230.00—T	\$
	Prof. Track Fri Only (see below)		\$250.00	\$
	Tech Track Fri Only (see below)		\$200.00	\$
	Banquet & Entertainment Only or Additional Tickets		\$65.00	\$
	Thu or Fri Lunch Ticket Only (includes breakfast & breaks)		\$50.00	\$

LUNCH CHOICE: () Veggie () Sirloin () Turkey-Thursday () Chicken-Friday

	Annual Meeting— please check for handout purposes	N/C	\$	N/C
	Past Presidents' Breakfast—RSVP REQUIRED	N/C	\$	N/C

Thursday All Day—includes workshops, continental breakfast, breaks, lunch, reception, banquet & entertainment
Friday Only—includes workshops, continental breakfast, breaks, lunch, & equipment show

Total Payment Due \$

Cancellation Policy
 Written cancellation request must be postmarked 20 days in advance for 100% refund.

Receive 20%* off for five (5) or more members or employees from the same company
 *20% discount only applies to Full Registration, or One-Day Only Registration

- Included in Full Registration**
- ◆ Two Days of Workshops with Continuing Education Units
 - ◆ Continental Breakfast (2)
 - ◆ Morning & Afternoon Breaks (2)
 - ◆ Lunch (2)
 - ◆ Reception
 - ◆ Banquet & Entertainment Equipment Show



Hotel Reservation Deadline
 DoubleTree by Hilton
 Downtown Manchester
 700 Elm Street
 Concord, NH 03101
 603-206-4216
November 16, 2023
Identify Affiliation with NHLSA

Method of Payment

Check (payable to NHLSA) () CHECK # VISA () MASTERCARD () AMERICAN EXPRESS () DISCOVER ()

Credit Card Number _____ Exp. Date ____/____

Name Appearing on Card _____ CVV (security code) _____

Address if different from above _____

CARDMEMBER ACKNOWLEDGES RECEIPT OF GOODS AND SERVICES IN THE AMOUNT OF THE TOTAL SHOWN HEREON AND AGREES TO PERFORM THE OBLIGATIONS SET FORTH BY THE CARDHOLDERS AGREEMENT WITH THE ISSUER.

Today's Date ____/____/____

- ◆ All registrations must be accompanied with payment
- ◆ Reservations cannot be taken by phone.
- ◆ **Send both pages**
- ◆ **Only one person and guest (members are not guests) per registration form**
- ◆ Make copies if needed

Mail or FAX Form (do not email credit card info)
 New Hampshire Land Surveyors Association (NHLSA)
 PO Box 689
 Raymond, NH 03077-0689
Phone: 603-895-4822 Fax: 603-386-6856
 Email for inquiries: info@nhlsa.org
Website for brochure or to register: www.nhlsa.org

WORKSHOP SELECTION

NHLSA 54th Annual Meeting & Equipment Show

WORKSHOPS

Thursday, December 7, 2023		
✓	#	Title · Room · Times · Continuing Education Units
	1	Increasing Your Professional Value · Pemigewasset Room · 8:00 AM - 4:00 PM · 2.0 NH CEUs
	2	PLLS Breakdown... · Merrimack/Contoocook Rooms · 8:00 AM - 4:00 PM · 2.0 NH CEUs
Friday, December 8, 2023		
	3	A Case Study: Legal Aspects for Survey Technicians · Pemigewasset Room · 8:00 AM - 10:00 AM · 0.50 NH CEUs
	4	NH Registry of Deeds—Protecting the Past... · Frost Room · 8:00 AM - 9:00 AM · 0.25 NH CEUs
	5	Top 10 Practical Lessons for Being an Effective LS in Court · Dartmouth Room · 8:00 AM - 10:00 AM · 0.50 NH CEUs
	6	Update on Grav-D and Progress Toward a New Geospatial... · Contoocook Room · 8:00 AM - 10:00 AM · 0.50 NH CEUs
	7	Rules of Construction · Merrimack Room · 8:00 AM - 10:00 AM · 0.50 NH CEUs
	8	Navigating the NH Shoreland Protection Act · Frost Room · 9:00 AM - 10:15 AM · 0.25 NH CEUs
	9	Northeast Surveying Societies (NESS) Roundtable · Piscataquog Room · 9:30 AM - 10:30 AM · 0.25 NH CEUs
	10	Panel Discussion on Business Operations · Pemigewasset Room · 10:15 AM - 12:15 PM · 0.50 NH CEUs
	11	Railroads in New Hampshire · Frost Room · 10:30 AM - 12:30 PM · 0.50 NH CEUs
	12	Micro Topics in Surveying · Dartmouth Room · 10:15 AM - 12:15 PM · 0.50 NH CEUs
	13	Surveying Software and Technologies · Contoocook Room · 10:15 AM - 12:15 PM · 0.50 NH CEUs
	14	Best Practices for Using Base Rover GNSS · Merrimack Room · 10:15 AM - 11:15 AM · 0.25 NH CEUs
	15	NHDES Subsurface Bureau Legislation Update · Merrimack · 11:15 AM - 12:15 PM · 0.25 NH CEUs
	16	New England Women Surveyors (NEWS) Roundtable · Piscataquog Room · 10:30 AM - 12:30 PM · 0.50 NH CEUs
	17	Exclusive Viewing of Exhibit Hall · Armory · 12:00 PM - 2:00 PM · 0.50 NH CEUs with submitted vendor card
	18	Technical Topics on Civil 3D for the Surveyor · Pemigewasset Room · 2:00 PM - 4:00 PM · 0.50 NH CEUs
	19	Young Surveyors Roundtable · Frost · 2:00 PM - 4:00 AM · 0.50 NH CEUs
	20	NSPS Certified Survey Technicians (CST) Program · Dartmouth · 1:00 PM - 5:00 PM
	21	The Zoning Board of Adjustment · Contoocook · 2:00 PM - 4:00 AM · 0.50 NH CEUs
	22	The Certified Floodplain Surveyor Program · Merrimack · 2:00 PM - 4:00 PM · 0.50 NH CEUs
	23	NH Board of Licensure for Land Surveyors Roundtable · Piscataquog Room · 2:00 PM - 4:00 PM · 0.50 NH CEUs
Reminder: Badge & meal tickets required for all events!		

Would you like a hardcopy 54th Annual Meeting Booklet? YES NO

Would you like a 2024 Souvenir Calendar? YES NO

CONVENTION REGISTRATION

IMPORTANT—Please help our speakers plan their handout material by filling out which workshops you plan to attend.

Please fill out both sides of the two-page registration form completely, and mail with payment to NHLSA. If paying by credit card, fax both sides, or register on the website.

EARLY BIRD FULL REGISTRATION—Save \$60 by registering before November 6th!

Thank You 2023 Presenters