



New Hampshire Land Surveyors Association

55th Annual Meeting & Equipment Show



Meet
Our
Sponsors

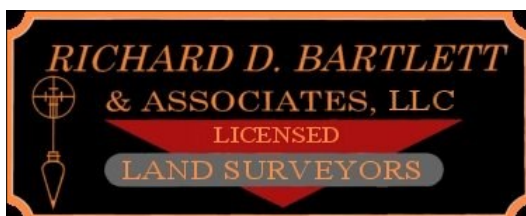

December 5—6, 2024

DoubleTree by Hilton
Manchester Downtown

700 Elm Street, Manchester, NH

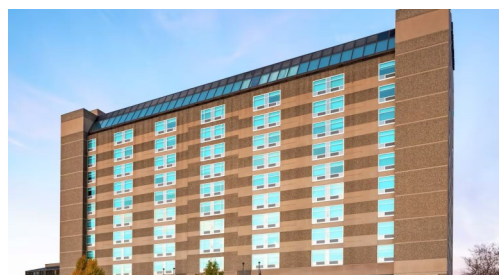

PROGRAM AT A GLANCE

REGISTRATION—ASSEMBLY

NHLSA 55th Annual Meeting & Equipment Show

Thursday
December 5, 2024

BADGES REQUIRED - ALL EVENTS

Please help your fellow members and guests identify you by name by wearing your badge. (meal tickets included in your badge)

7:30 AM

◆ **Registration Desk Open (Assembly)**

◆ **Continental Breakfast (Assembly)**

Assorted breakfast breads, sweet cream butter and fruit preserves, sliced seasonal fruit, orange, cranberry & apple juice, Starbucks regular & decaffeinated coffee, and assorted Tazo hot teas

(Pemigewasset Room)

8:00 AM—10:00 AM

◆ **Session 1: Professional Track: Ethics, Morals, and Principles for the Surveyor (2.0 CEUs)**

(Merrimack/Contoocook Rooms)

8:00 AM—10:00 AM

◆ **Session 2: Technician Track: The Technicians Track to Licensure (2.0 CEUs)**

10:00 AM—10:15 AM

◆ **Morning Break (Assembly)** Seasonal infused water, Starbucks regular and decaffeinated coffee and assorted Tazo hot teas

10:15 AM—12:00 PM

◆ **Session 1: Who Are We? A Public Relations Primer for Surveyors**

◆ **Session 2: Continued**

12:00 PM—1:00 PM

◆ **Lunch Buffet (Assembly)**

Deli Express Buffet: **Starters:** Chef's soup selection, chop salad w/kale, Brussel sprouts, red cabbage, carrot blend with balsamic dressing; **Sandwiches:** Smoked turkey breast w/avocado, tomatoes, Monterey jack cheese, fresh herb mayonnaise on nine-grain whole wheat bread, Sliced slow-roasted beef w/cheddar cheese, horseradish aioli, lettuce, tomato on ciabatta bread, Herbed grilled vegetables w/roasted tomato hummus, lettuce, sliced tomato, garlic-herb wrap; **Accompaniment:** Garlic and parmesan cheese chips; **Dessert:** Assorted cookies, brownies, and blondies; Starbucks regular and decaffeinated coffee, and assorted Tazo hot teas.

1:00 PM—2:15 PM

◆ **Session 1: NSPS: The National Advocate for the Surveyor (Workforce Development, Certificates vs. Licensure, and The NSPS Certified Survey Technician (CST) Program: The Pathway to Building a Future-Proof Career**

◆ **Session 2: Continued**

2:15 PM—2:30 PM

◆ **Afternoon Break (Assembly)**

Fruit kabobs with honey yogurt dipping sauce, assorted cookies, lemonade, bottled still water

2:30 PM—3:30 PM

◆ **Session 1 & 2: continued**

3:30 PM—4:00 PM

◆ **Seminar wrap-up, Q&A, & Committee Meetings**

4:00 PM—6:00 PM

◆ **Business Meeting, Awards (Pemigewasset Room)**

6:00 PM—7:00 PM

◆ **Reception (Penstock Room)**

Hors d'oeuvres: Bacon wrapped scallops (panko crumbs and parmesan cheese) and Teriyaki beef sirloin satay (tender beef with teriyaki glaze)

◆ **Foundation Live Benefit Auction featuring Eric Mitchell.**

7:00 PM—9:00 PM

◆ **Banquet Buffet—Memorial Park (Three Rivers—Piscataquog, Merrimack, Contoocook)**

Salad: Mixed greens (bacon, shredded cheddar, heirloom tomatoes, shaved red onion), Caprese (mixed greens, pesto marinated mozzarella, heirloom cherry tomatoes, balsamic glaze); **Entrees:** Roasted Salmon (dill and lemon beurre blanc), and Herb crusted roasted pork loin (apple and brown sugar glaze); **Accompaniment:** Duchess potatoes and mixed vegetable medley; **Dessert:** Warm apple tart (vanilla bourbon whipped cream); Freshly baked assorted rolls and butter, Starbucks regular and decaffeinated coffee, and assorted Tazo hot teas.

◆ **Entertainment: JD and the Stonemasons**

**Session 4:
Certified Survey
Technicians Program
8:00 AM - 12:00 PM**

Note: Please advise of any special meal requests, e.g., vegetarian, gluten-free, etc., when you RSVP.

PROGRAM AT A GLANCE

REGISTRATION—ASSEMBLY

NHLSA 55th Annual Meeting & Equipment Show

Friday December 6, 2024

7:30 AM

♦ Registration Desk Open (Assembly)

♦ **Continental Breakfast (Armory)**

Same as Thursday

7:30 AM—9:00 AM

♦ **Past Presidents' Breakfast (Piscataquog Room)**

Riverside: Scrambled farm fresh eggs, French toast with maple syrup, Applewood smoked bacon, Pork sausage, Breakfast potatoes, Seasonal fresh fruit and berries, Fruit yogurts, Assorted cereals, orange juice, Starbucks regular & decaffeinated coffee, and assorted Tazo hot teas.

8:00 AM—4:00 PM

♦ **Exhibit Hall Open (Armory)**

Concurrent Sessions

8:00 AM—10:00 AM

♦ **Session 3: Using GIS and Other Data in your CAD Plans (Pemigewasset Room)**

8:00 AM—12:00 PM

♦ **Session 4: NSPS CST Program (Dartmouth Room)**

8:00 AM—10:00 AM

♦ **Session 5: The Last Mile: Final Push for New Datums, Progress, and What is Still to Come (Contoocook Room)**

8:00 AM—9:00 AM

♦ **Session 6: Social Media and the Professional Land Surveyor (Merrimack Room)**

9:00 AM—10:00 AM

♦ **Session 7: Accuracy and Precision 2024 (Merrimack Room)**

9:30 AM—10:30 AM

♦ **Session 8: NESS Roundtable (Piscataquog Room)**

10:00 AM—10:15 AM

♦ **Morning Break (Armory)**

Same as Thursday

10:30 AM—12:30 PM

♦ **Session 9: AutoCAD and Civil3D Intermediate Skills – Dynamic Blocks and Special Assemblies (Pemigewasset Room)**

10:15 AM—12:15 PM

♦ **Session 10: Practical Solutions for Surveying with GPS (Contoocook Room)**

10:15 AM—11:15 AM

♦ **Session 11: Shoreland—TBD (Merrimack Room)**

10:30 AM—12:30 PM

♦ **Session 12: Women in Surveying (Piscataquog Room)**

11:15 AM—12:15 PM

♦ **Session 13: NHDES Subsurface Bureau Update (Merrimack Room)**

12:00 PM—2:00 PM

♦ **Session 14: Exclusive Viewing of Exhibit Hall (Armory)**

12:00 PM—1:30 PM

♦ **Lunch Buffet (Armory)**

Southern Comfort: Entrees: BBQ shredded chicken, BBQ pulled pork; **Accompaniment:** Redskin potato salad (onion, celery, creamy), Coleslaw (traditional cream based), Mac and cheese (cheddar, mozzarella and smoked gouda, panko-herb crusted), Baked beans (brown sugar, caramelized onions, infused smoked bacon), Roasted Brussel sprouts (bacon bits, caramelized onion), Cornbread (traditional southern style); **Dessert:** Apple pie, pecan pie; Starbucks regular and decaffeinated coffee and assorted Tazo hot teas

Concurrent Sessions Continued

2:00 PM—3:00 PM

♦ **Session 15: Social Media and the Professional Surveyor (Pemigewasset Room) - will move to the YSC Roundtable from 3:00-4:00 PM**

2:00 PM—4:00 PM

♦ **Session 16: No, This is Not OK and other Essential Lessons on Total Station and Level Use (Dartmouth Room)**

3:00 PM—3:15 PM

♦ **Afternoon Break (Armory)**

Same as Thursday

50/50 raffle drawing

2:00 PM—4:00 PM

♦ **Session 17: The Zoning Board of Adjustment: Strategies for Surveyors, Traps for the Unwary, and 2024 Updates in the Law (Contoocook Room)**

2:00 PM—4:00 PM

♦ **Session 18: Datum Modernization and NH State Coordinate System (Merrimack Room)**

2:00 PM—4:00 PM

♦ **Session 19: Young Surveyors Roundtable; The last hour will include Social Media and the Professional Surveyor (Piscataquog Room)**

See page 8 for DES sessions.

Remember to sign in/out for each session to receive continuing education units (1/4 CEU for each hour session attended). Attendees must attend entire session to receive full credit.

NHLSA 55 th Annual Workshop Schedule					
DoubleTree by Hilton Manchester Downtown - Manchester, NH					
REGISTRATION: 7:30 AM		December 5, 2024			Assembly Foyer
Pemigewasset Ballroom	2.0 CEUs	Session 1: Multiple Topics (see pages 5 & 6) Timothy W. Burch, PLS			8:00 AM - 4:00 PM
Contoocook & Merrimack	2.0 CEUs	Session 2: The Technicians Track to Licensure Eric Salovitch & Tasha Huhta			8:00 AM - 4:00 PM
Sign-in/out to receive continuing education units (1/4 ceu will be awarded for each hour session attended) (must attend entire session to receive full credit)					
REGISTRATION: 7:30 AM		December 6, 2024			Assembly Foyer
TIMES					Piscataquog
7:30 AM 12:00-2:00 PM	Continental Breakfast, Breaks & Lunch in Armory				Past Presidents Breakfast 7:30 - 9:00 am
8:00 AM 4:00 PM	Equipment Show in Armory				
TIMES	Pemigewasset	Dartmouth	Contoocook	Merrimack	
8:00 AM	Session 3: Using GIS and Other Data in your CAD Plans 8:00 - 10:00 am	Session 4: CST EXAM 8:00 - 12:00 pm	Session 5: The Last Mile: Final push for new datums, progress, and what is still to come 8:00 - 10:00 am	Session 6: Social Media and the Professional Surveyor 8:00 - 9:00	Room clean-up 9:00 - 9:30 am
8:30 AM					
9:00 AM					
9:30 AM			Session 7: Accuracy & Precision 2024 9:00 - 10:00	Session 8: NESS 9:30 - 10:30 am	
10:00 AM			Break		
10:30 AM	Session 9: AutoCAD and Civil3D Intermediate Skills – Dynamic Blocks and Special Assemblies 10:30 am - 12:30 pm	Break in between session	Session 10: Practical Solutions for Surveying with GPS 10:15 am- 12:15 pm	Session 11: Shoreland—TBD 10:15 am - 11:15 pm	Session 12: Women in Surveying Roundtable 10:30 - 12:30 pm
11:00 AM				Session 13: NHDES Subsurface Bureau Update 11:15 am - 12:15 pm	
11:30 AM					
12:00 PM					
12:30 PM	Lunch 12:00 pm –1:30 pm	Session: 14: (12:00—2:00 PM) Viewing Time for Exhibitors Don't forget to get your vendor card stamped. If you receive a stamp from every vendor, you will receive 0.5 CEU.			
1:00 PM					
1:30 PM					
2:00 PM	Session 15: Social Media and the Professional Surveyor (continued in YSC Roundtable) 2:00 pm - 3:00 pm	Session 16: No, This is Not OK and other Essential Lessons on Total Station and Level Use 2:00 - 4:00 pm	Session 17: The Zoning Board of Adjustment: Strategies for Surveyors, Traps for the Unwary, and 2024 Updates in the Law 2:00 pm - 4:00 pm	Session 18: Datum Modernization and NH State Coordinate System 2:00 pm - 4:00 pm	Session 19: Young Surveyors Committee Roundtable 2:00 - 3:00 pm Social Media and the Professional Surveyor 3:00 - 4:00 pm
2:30 PM					
3:00 PM					
3:30 PM					
4:00 PM					
4:30 PM					
5:00 PM					
Certificates will be mailed					

SEMINAR ★ THURSDAY, DECEMBER 5th

NHLSA 55th Annual Meeting & Equipment Show

Thursday's Sponsors

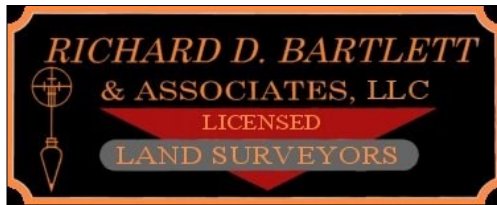

Continental Breakfast

(1)

Timothy W. Burch, PLS

8:00 AM—ETHICS, MORALS, AND PRINCIPLES FOR THE SURVEYOR

Professional licensure carries a large responsibility that is predominantly unseen by the public we serve. For many surveyors, there are additional requirements of continuing education that must be met to retain the privilege of holding a professional license.

The ethics of a professional surveyor are the principles that govern the behavior of a person or group in a business environment. Like values, professional ethics provide rules on how a person should act towards other people and institutions in such an environment. But how do ethics relate to one's morals and principles? Can a person be ethical but not moral? Or vice versa?

The surveying profession is changing with the introduction of newer generations and the exit of older ones. As the business of surveying evolves, the guiding ethics, morals, and principles will also evolve. This session seeks to find where our profession is headed in continuing to uphold our duties to the public.



Morning Break

10:00 AM—WHO ARE WE? A PUBLIC RELATIONS PRIMER FOR SURVEYORS

The professional surveyor has never been known for standing out in the spotlight. As a somewhat subdued profession, we have shied away from attention and notoriety to quietly go about our business. In today's world, however, being bolder and more outspoken has become the key to being noticed by the environment around us. A solid public relations program is the key to promoting the profession and social media has become a major part of this "megaphone of information" method of communication utilized by nearly everyone. So how does the professional surveyor join the masses and embrace this extroverted method of communication?

This session sets out to discuss the ways surveyors can promote their profession. Topics covered during this conversation include:

- ◆ Increased Visibility and Brand Awareness
- ◆ Recruitment and Talent Acquisition
- ◆ Education and Public Awareness
- ◆ Networking and Relationship Building
- ◆ Crisis Communication and Reputation Management



Lunch

1:00 PM—NSPS: THE NATIONAL ADVOCATE FOR THE SURVEYOR

WORKFORCE DEVELOPMENT

The biggest challenge to the surveying and geospatial professions in today's environment is workforce development; how do we "fix" it? It seems as if we cannot agree on the "education versus experience" argument. We also do not have any real solutions on how to make this profession more attractive to a younger generation that includes more women and minorities. The profession also faces a public perception problem; are we a profession or a trade? And why is that distinction a big deal?

This session offers a look into how we got here and ideas for bridging the generational gap to find effective solutions for the immediate and distant future.

CERTIFICATES VS. LICENSURE

For many years, the central figure in professional surveying was the licensed individual. But with emerging technology being a driving force for most surveying tasks being completed, the requirement for licensed oversight has become a question mark in the industry.

SEMINAR ★ THURSDAY, DECEMBER 5th

NHLSA 55th Annual Meeting & Equipment Show

Technical competence for hardware and software applications can now be tested through various certifications but does not meet criteria for many specific items normally tested through national and state licensing exams. However, does the licensed surveyor have the necessary competency to truly oversee today's technical work being completed by certified technicians? This session explores the pros and cons of licensing and certification with our profession, so bring your best justification for each to debate.

THE NSPS CERTIFIED SURVEY TECHNICIAN (CST) PROGRAM: THE PATHWAY TO BUILDING A FUTURE-PROOF CAREER

For many years, the central figure in professional surveying was the licensed individual. But with emerging technology being a driving force for most surveying tasks being completed, the overall need for technically competent field and office surveyors has become the number one priority for employers. Training and testing utilizing the NSPS Certified Survey Technician (CST) program can help employees and employers alike determine one's ability and competence within the surveying profession. This session provides an overview of the program as well as offering strategies for encouraging current and future technicians to see the value of certification in which to build their career.

Tim is the Executive Director of the National Society of Professional Surveyors (NSPS). He also served as President-Elect, Vice President, and Secretary (2015-2019) of the NSPS Board of Directors, and as Governor/Director representing Illinois (2007-2014). Tim has been involved with the organization for more than 20 years as a member of the Certified Survey Technician Board, Joint Government Affairs, and ALTA/NSPS Land Title Survey committees.



Tim serves as Chair for the International Federation of Surveyors (FIG) Commission 1 (Professional Standards, 2023-2026) and serves as the Advisory Committee of Commission Chairs representative to the FIG Council. He also led the local organizing group in partnering with FIG to host the annual Working Week 2023 in Orlando.

As part of his role as NSPS Executive Director, Tim serves as association liaison to the International Property Measurement Standards and International Ethics Standards working groups as well as maintaining communication with likeminded surveying associations from around the world.

In addition to content manager for NSPS social media, Tim is the creator and producer of the NSPS podcast "Surveyor Says!" and the managing editor for both the NSPS newsletter "News and Views" and the recently introduced "Surveyor Says! The NSPS Bulletin." He also serves as a Brand Ambassador for the "Get Kids into Survey" (GKIS) initiative created by Elaine Ball and was instrumental in establishing NSPS as the North America distributor for the GKIS posters and educational material.

Mr. Burch is a Professional Land Surveyor licensed in the States of Illinois and Wisconsin. He recently relocated with his wife, Susan, to West Virginia after many years in Illinois.

8:00 am—4:00 pm
Pemigewasset Room

2.0 NH LLS CEUs 6

(2) The Technicians Track to Licensure

Eric Salovitch, LLS
Tasha Huhta, LS

This session will cover the track to licensure starting with National and State requirements, necessary work experience, what's responsible charge, and portfolio construction. Learn more about what it means to become a professional and helpful tips to guide your professional career. Set goals and create a plan to chase them. We will briefly overview material related to New Hampshire licensure with tips on available resources. There will be a boundary problem presented with peer guidance and discussion. The remaining time will be spent as a Young Surveyors Committee working session planning the 2025 season for the NH YSC.

Eric graduated from the University of New Hampshire with a Surveying and Mapping Civil Technology Degree in 2010. He is the President and CEO of Northam Survey, LLC established in 2021. He is a Licensed Land Surveyor in New Hampshire, Maine, and Massachusetts. Eric is the former Chair and co-founder of the New Hampshire Young Surveyors Committee. Eric is Past President of the Association serving as the 54th President!



This interactive presentation is designed to illuminate the essential elements of effective mentoring. Participants will explore the concept of mentoring, the importance of selecting the right mentor, and how to make the most of the mentoring relationship. Through engaging exercises and group discussions, attendees will gain the skills and insights needed to thrive as both mentors and mentees. This workshop is ideal for individuals at all career stages seeking to enhance their mentoring skills, whether as a mentor or mentee. Join us for this enriching experience and take the next step in your professional journey through the power of mentorship!

Tasha is a Federal Internal Coach, Cadastral Training Coordinator and CFedS Program Manager virtually located in Phoenix, AZ & physically located in Anchorage, AK. In 1998 she started her career in Colorado as a SCEP Land Surveyor. Tasha transferred to BLM-Alaska in 2001 & worked various positions in the Field, Review, and Contracts Sections. In 2013 she was promoted to Supervisory Land Surveyor, Cadastral Office Section & in 2018 she transitioned to Cadastral Training Coordinator, BLM-NTC. Tasha completed a Bachelor of Professional Studies, Surveying and Mapping, 2001, Metropolitan State College of Denver. She is passionate about training and development, and committed to lifelong learning of OJT, skilled professionals, and the world around her.



8:00 AM - 4:00 PM
Contoocook/Merrimack Rooms

2.0 NH LLS CEUs

SPECIAL EVENTS ★ THURSDAY, DECEMBER 5th

NHLSA 55th Annual Meeting & Equipment Show



Afternoon Break

NHLSA COMMITTEE MEETINGS

I encourage all Committee Chairs to take the opportunity to meet with your committee members for this brief period before the Annual Business Meeting.

Ryan Fowler, LLS
President

Pemigewasset Room 3:30 PM - 4:00 PM

NHLSA ANNUAL BUSINESS MEETING, AWARDS, & INSTALLATION CEREMONY

The New Hampshire Land Surveyors Association is wrapping up the year at our 55th Annual Meeting and Equipment Show. Everyone is invited to attend our Annual Meeting where important agenda topics will be addressed. Business includes an update on the website, and budget review, specifically legislation. We look forward to seeing you all there.

Ryan Fowler, LLS
President

Pemigewasset Room 4:00 PM - 6:00 PM

NHLSA RECEPTION WITH HORS D' OEUUVRES, CASH BAR, NHLF LIVE BENEFIT AUCTION AND RAFFLE

If elected at the Installation Ceremony, I will be your new President for our 56th year and I invite you to join me for our evening activities. Our reception, with hors d'oeuvres and cash bar, will again feature our 50/50 raffle. Seth Burnell, Vice President, and I will be canvassing the conference, selling tickets throughout Thursday and Friday until noon. The final drawing will be on Friday! If you don't see Craig or Seth, 50/50 tickets will also be available at the registration table throughout both days.

50/50

While mingling with colleagues, and hopefully not spent all of your money on raffle tickets and saved some for the possible bidding wars of the NHLF Live Auction. With the retirement of Terry Eldredge, Eric Mitchell is planning to return, and continue his lively and fun hosting duties, with the assistance of our generous volunteers.

Craig T. Bailey LLS
President-Elect

Penstock Room 6:00 PM - 7:00 PM



HALEY WARD.
ENGINEERING | ENVIRONMENTAL | SURVEYING

Reception

NHLSA AWARDS BANQUET

I invite you to join me for the Awards Banquet, enjoy a good meal, continued conversation with friends, or someone you have yet to meet, and the fun will continue when the LIVE BAND starts. They will begin while we're in the buffet line, background music during dinner, and once dinner is complete, we hope you'll get up on the dance floor and show us your moves.

The New Hampshire Land Surveyors Foundation is accepting donations, small, large, or in between. This year, the proceeds will benefit the Scholarship Fund. We can always expect a wide variety of items that will interest all banquet attendees, members, and guests alike. If you have any items that you would like to donate to the auction, please fill out the enclosed auction form and email it to Barbara ahead of time or drop it off with the item at the registration desk.

As for the winning Map Contest entries, don't forget to stop by the registration table to claim your drink ticket!



We will end the evening with a door prize. Members who register for two days will receive a ticket during registration, and you must be present to win.

Since the 50/50 raffle extends through two days, you need not be present to win, just write your name on the ticket you drop in the provided fishbowl. The winning ticket holder will receive half of the proceeds with the remaining half donated to the Robert G. Moynihan Education Fund.

Seth Burnell, LLS, Vice President

Three Rivers 7:00 PM - 9:00 PM
Piscataquog, Merrimack, Contoocook

The Silent Auction will open during lunchtime on Thursday and close following the Friday afternoon break. When you recycle your badge at the end of the day, check out the list of lucky recipients. If you can't stay for the entire event, please consider making arrangements for picking up your winning item.



If you have an item for the auction but will not be able to attend, please contact Barbara Cormier or Seth Burnell and they will make sure it gets on the auction block.

Thursday December 5 - Friday, December 6, 2024

ENTERTAINMENT & DES APPROVED SESSIONS

SPONSORS

NHLSA 55th Annual Meeting & Equipment Show



Please join us as we welcome our evening entertainment, JD and The Stonemasons.

JD and The Stonemasons is an Irish American roots band based in Sunapee, New Hampshire. They released their first album "Pickpocket Road" in 2023 and are currently wrapping up their second album due for release in November.

They have gigged and toured extensively throughout Maine, New Hampshire, Vermont and beyond, including events at the Mount Washington Hotel, Killington Resort and the Bank of NH stage in Concord as well as countless bars and barn dances. They recently returned from a festival in Kansas where they played for thousands of attendees.

Their music ranges from foot-tapping and partner-swinging folk music to Irish ballads, bluegrass and old country favorites. The band includes two land surveyors and will be joined by surveyor Andy Nadeau.



DEPARTMENT OF ENVIRONMENTAL SERVICES

DES has approved credits for the following sessions, for septic designers & installers.

Sessions 1, 3, 5, 7, 9, 10, 11, 13, 16, 17, 18
One (1) credit hour = seat time
(length of workshop)

- ◆ Thursday Continental Breakfast
Richard D. Bartlett & Associates, LLC
- ◆ Thursday Morning Break
James Verra & Associates, Inc.
- ◆ Thursday Lunch
Alfano Law, PLLC
- ◆ Thursday Afternoon Break
Keystone Precision Solutions
- ◆ Thursday Reception
Haley Ward, Inc.
- ◆ Friday Continental Breakfast
VHB, Inc.
- ◆ Friday Morning Break
GM2 Associates, Inc.
- ◆ Friday Lunch
Doucet Survey, Inc.
- ◆ Friday Afternoon Break
James Verra & Associates, Inc.
- ◆ Past Presidents Breakfast
Maine Technical Source
- ◆ Parking for all attendees
Northam Survey, LLC
Jones & Beach Engineers, Inc.
- ◆ Wi-Fi (**Mentor!**) for all attendees
Doucet Survey, LLC

Thank You
to our Sponsors!

- ◆ 2025 Souvenir Calendar

Waypoint
TECHNOLOGY GROUP

Friday's Sponsors



Past Presidents Breakfast

PAST PRESIDENTS BREAKFAST

Ryan Fowler, incoming Chair, welcomes all Past Presidents to assemble and partake in the discussion on the following topics:

- ◆ Elect a taker of minutes
- ◆ **Group photo to be taken at 7:50 AM sharp!**
- ◆ Report on discretionary fund
- ◆ NSPS News and Views and related benefits of membership
- ◆ Brief discussion on young surveyors groups across the New England region

Please contact President Fowler prior to December 1st regarding any other topics for discussion at the breakfast.

Piscataquog Room

7:30 AM - 9:00 AM



Continental Breakfast

Remember to sign in/out for each session to receive continuing education units (1/4 CEU for each hour session attended). Attendees must attend entire session to receive full credit.

(3) Using GIS and Other Data in your CAD Plans

Rick Ladd

In this class we will look at ways to include GIS data from GRANIT and other sources for use in your CAD drawings and project planning. Quickly obtain information for your drawings from multiple sources. We will also investigate other tools and tips in CAD to make your drawings easier to create and more efficient. We will also explore maps to collect your data in the field and import them into your CAD drawings.

Rick is President of CADNET Services, LLP, a single source provider of CAD, CAD training, and IT solutions. With over 26 years of experience in CAD systems and engineering, Rick has become an industry resource on latest trends in surveying system technology. Rick was an Adjunct Faculty member with the University of NH for 13 years, where he worked as a CAD instructor for Civil Engineering students; today he offers the same field-tested expertise in virtual training at www.cadnetservices.com. Connect with Rick on LinkedIn.



8:00 AM - 10:00 AM
Pemigewasset Room

0.50 NH LLS CEUs

(4) National Society of Professional Surveyors Certified Survey Technicians (CST) Program

Scott Boudreau, LLS
Proctor

The NSPS CST (Certified Survey Technician) program is a **national certification program** for Survey Technicians (based on experience and examination for field and office) at four levels (Level I; entry level, Level II; instrument/computer operator, Level III; party chief/chief computer operator, and Level IV; chief of parties/office manager). It is sponsored by the National Society of Professional Surveyors. The Certified Survey Technician Board (CST Board) administers the program, which is intended to gauge technical capabilities and general knowledge of workplace safety and procedures. Four levels of certification are offered in two primary tracks – field, and office.

The CST program is a way to help our technicians advance in their careers. The testing allows for confirmation of abilities, provides additional education, potential career advancement, and a greater sense of well-being and contribution. We need to encourage our technicians to expand their skill sets and advance in the profession. The CST program is a way to accomplish some of these goals. I would encourage all employers to support their technicians in this career advancement. The CST Program is sponsored by the Association through the R.G. Moynihan Education Fund grant program. The Fund will provide 50% of the cost of the examination to technicians who successfully complete testing at any CST Level, any time they test. **The next scheduled testing will be on December 6th, beginning with a 7:45am check in, and will be held from 8am to 12pm at the NHLSA Annual Meeting and Equipment Show at the Manchester**

WORKSHOPS ★ FRIDAY, DECEMBER 6th

NHLSA 55th Annual Meeting & Equipment Show

Double Tree, located at 700 Elm Street, Manchester, NH. Go to <https://cstnsp.com/apply-online/> to apply. The deadline for this test cycle is November 29th.

The additional education and preparation that the CST program offers can be of great benefit to survey technicians, NHLSA, its members, and future members, by insuring a well-trained work force. In addition, the CST testing program helps to prepare technicians who are looking to track into licensure with exam practice and material competency.

8:00 AM - 12:00 PM

Dartmouth Room



(5) The Last Mile: Final Push for New Datums, Progress, and What is Still to Come

Dan Martin, LS

NSRS Modernization has and continues to be a significant undertaking. In addition to new paradigms related to datum definitions, it has also required NGS to rethink how we collect, process, store, manipulate, and deliver data. In this session, we will review the need and status of the major projects associated with NSRS Modernization.

Dan has worked for the National Geodetic Survey since 2003, and has been the Northeast Regional Geodetic Advisor since 2015. As the Regional Advisor, he instructs local surveyors, state and municipal agencies, and the geospatial community at large, on how to use and preserve the National Spatial Reference System, and provides liaison between the National Geodetic Survey and the States of ME, NH, VT, MA, CT, RI, NY, and NJ, as well as other federal agencies. Prior to that he worked in the Route Survey and Geodetic Survey sections of the Vermont Agency of Transportation from 1988 through 2003, and held the position of Geodetic Program Supervisor for the Agency from 1999 through 2003. Dan is a Past President and Fellow Member of the American Association for Geodetic Surveying (AAGS), and an Honorary Member of Vermont Society of Land Surveyors and New Hampshire Land Surveyors Association.



8:00 AM - 10:00 AM
Contoocook Room

0.50 NH LLS CEUs

(6) Social Media and the Professional Surveyor

Timothy W. Burch, PLS

Based upon the stereotypical demographics of the surveying profession, digital and social media is not a strong suit of its practitioners. However, outdated media sources (terrestrial television and radio, outdoor advertising and traditional print media, including newspapers and magazines) are NOT where our profession needs to be telling our stories.

This session is a town hall style of discussion where attendees are encouraged to share all ways to promote our beloved profession to future surveyors AND to the general public which we serve. Bring your best suggestions on how we can share our outreach on these topics:

- ◆ Highlight the Importance of Surveying: Create campaigns that emphasize the crucial role surveying plays in society.
- ◆ Promote the Career Path of a Surveyor
- ◆ Showcase the Latest Technology in Surveying
- ◆ Address Misconceptions About Surveying
- ◆ Leverage Social Media
- ◆ Build Relationships with the Media

Together, we can build our message to attract more interest in our profession across the proper platforms.

8:00 AM - 9:00 AM
Merrimack Room

0.25 NH LLS CEUs

(7) Accuracy & Precision 2024

Jim Peterson, PE, PLS, Ph.D.
Tommy Nichols

Part I - Definition

Types of Error
Gross - Systematic - Random
Basic Error Theory
Normal error distribution

Part II - Survey Instruments

Considerations for Total Stations
Instrument Errors
Total Station calibration
EDM Technology
Accessories
Care of Instruments
Considerations for Modern Levels
Specifications
Digital level calibration
Combining Total Stations & GNSS observations
Total Station setups using GNSS points
Control points

Part III - Newer Survey Instrument Technology

GNSS with Tilt technology
How does it work?
GNSS with Imaging Technology
How does it work?
Prism pole with Tilt Technology
How does it work?

WORKSHOPS ★ FRIDAY, DECEMBER 6th

NHLSA 55th Annual Meeting & Equipment Show

Dr. Peterson is a Support Representative for Leica Geosystems. He has over 36 years of experience as a professional surveyor, engineer, constructor, mapper, educator, and researcher with his FAA Remote Pilot Certificate. His career took him across North America, Europe, and Australia promoting mobile mapping and unmanned aircraft systems (UAS). He was an Assistant Professor at Missouri State and program coordinator of the UAS degree at Southeast Missouri State. Previously he was a lecturer at Southern Illinois University at Edwardsville (SIUE) and Missouri University of Science and Technology (MST) where he completed his Ph.D. in C.E. (2015)



His professional career includes Consolidation Coal Company, McCarthy Bridge & Heavy, the Center of Expertise for Photogrammetric Mapping at the U. S. Army Corps of Engineers. He has been a Vice-President of aerial mapping companies, managed and owned several engineering, surveying, construction companies, and a Domain Expert for Trimble Navigation and Gatewing.

Tommy has been a Support Technician with Leica Geosystems for twenty years. Received his LSIT in 2003 while employed with the Virginia Department of Transportation as GPS Coordinator Hampton Roads District (employed 17 years). He studied at Old Dominion University receiving an Engineering Technology apprenticeship through VDOT. Tommy also worked in the private sector for eight years within his VDOT employment as a survey project manager working nationally and abroad.

9:00 AM - 10:00 AM
Merrimack Room

0.25 NH LLS CEUs



Morning Break

(8) North East Surveying Societies (NESS Roundtable)

Craig T. Bailey, LLS #1001
Moderator

Join me and other North East State Presidents for an informal NESS meeting to continue our ongoing dialogue and initiatives. Regional issues such as metrics on membership and young surveyor groups are key to the success of all state societies and NSPS.

We'll discuss the challenges we've overcome during the last few years, and how we have been integrating hybrid participation as remote participation, clearly creates value to our memberships. In addition, we'll

touch on recent efforts to introduce additional educational opportunities to the New England area, including the addition of our Technician Track at our Annual meeting and future meetings.

Please feel free to contact me prior to the meeting at cbailey@nhlsa.org.

9:30 AM - 10:30 AM
Piscataquog Room

0.25 NH LLS CEUs

(9) AutoCAD and Civil3D Intermediate Skills - Dynamic Blocks and Special Assemblies

Craig T. Bailey, LLS, PE, PSM
Thomas W. Schomburg, EIT, SE

Join us to pick up some tips-n-tricks in AutoCAD and Civil3D. Have you ever wondered what all those strange tools are when you pop into the Block Editor? Do you have any typical details that always need a little tweaking to fit on the sheet? Dynamic Blocks might be what you're missing in life!

Have you ever needed to grade a site with feature lines, only to need to adjust every single blasted one for small changes? Have you ever said 'there must be a better way'? Perhaps a multi-baseline corridor is the answer, where grade control and horizontal control are provided by a few objects! Craig and Thomas will have several examples prepared and will focus on the *Assembly* components of some nonstandard corridors. Bring your questions and you'll be provided some answers.

This 2-part course is intended for septic designers, land surveyors, and engineers who have used AutoCAD before, and the second hour for folks who are familiar with the basics of Corridor development in Civil3D.

Craig has focused on the implementation of technology and software to provide better, more effective land development services. A second-generation land surveyor, Craig had opportunities that most kids didn't... namely access to AutoCAD version 10! Since early 1987, Craig has used almost every version of AutoCAD, and has served as a contract consultant to Autodesk, assisting large DOT's with Civil 3D implementation. Craig has spent dozens of hours in the classroom teaching AutoCAD and others – all to improve practitioners understanding of software interoperability with respect to the Land Development industry. Craig is one of the principals at Bryan L. Bailey Associates, where he focuses on all aspects of land development permitting and design. Holding degrees in Civil Engineering and Land Surveying Engineering Technology, Craig brings a unique perspective to the use and implementation of AutoCAD and Civil 3D in the land surveying office.



Note: Natural Scientists credits are not pre-approved, use your best judgment when choosing your sessions.

WORKSHOPS ★ FRIDAY, DECEMBER 6th

NHLSA 55th Annual Meeting & Equipment Show

Thomas is a project engineer with experience in CAD design and surveying, having graduated from NHTI (2018) and Merrimack College (2021). He has worked with Civil Design Consultants, Inc. since 2018, preparing site plans and drainage reports for residential and commercial developments throughout Southern New Hampshire and Massachusetts. Thomas is also certified as a Part 107 remote pilot and serves as his company's primary remote-pilot-in-command for aerial survey work, producing high resolution, georeferenced orthomosaics, digital topography, and 3D models to aid in plan preparation. Thomas works extensively with AutoCAD Civil3D, HydroCAD, and Pix4D, with a focus on optimizing processes and utilizing the tools in each software.



10:30 AM - 12:30 PM
Pemigewasset Room

0.50 NH LLS CEUs

(10) Practical Solutions for Surveying with GPS

Eric Salovitch

This session will provide a quick overview of Surveying with GPS. Providing helpful tips for users using Real Time Network (RTN) and Real-Time Kinematic (RTK) surveying techniques and how to maximize efficiency while limiting potential problems. This is not a least squares analysis course and will have limited conversation on such. We will however discuss ways of collecting data and what to "feed" adjustment software for best probable outcomes. Come learn about what can affect GPS locations and tools available to help prevent inaccuracies.

Eric graduated from the University of New Hampshire with a Surveying and Mapping Civil Technology Degree in 2010. He is the President and CEO of Northam Survey, LLC established in 2021. He is a Licensed Land Surveyor in New Hampshire, Maine, and Massachusetts. Eric is the former Chair and co-founder of the New Hampshire Young Surveyors Committee. Eric is Past President of the Association serving as the 54th President!



10:15 AM - 12:15 PM
Contoocook Room

0.50 NH LLS CEUs

(11) Shoreland Update

TBD

10:15 AM - 11:15 AM
Merrimack Room

0.25 NH LLS CEUs

(12) Women in Surveying Roundtable

Cynthia Boisvert, LLS
Moderator

Join us as we discuss topics relevant to being a woman in a predominantly male field. This is a group that was formed five years ago in the hopes of getting more of us together in one place from NH and other New England states. We would like to set some goals this year and formalize a mission for our group, and discuss becoming involved in STEM schools, focusing on introducing young women to our profession.

Cynthia has been a NH Licensed Land Surveyor for 38 years, beginning her survey career in North Conway, NH, working for HEB Engineers and Burnell Land Surveying. Since 1980, she has been working in southern NH. Six years as VP of Survey Services at Cuoco & Cormier, Inc. and currently as President of Arago Land Consulting, LLC, located in Amherst NH. Cynthia has served the NH Land Surveyors Association, as Vice President, President Elect, President, Past President, and Publications Director, and is currently the Registry of Deeds Liaison. She has a BS in Environmental Design from the University of Massachusetts, Amherst.



10:30 PM - 12:30 PM
Piscataquog Room

0.50 NH LLS CEUs

(13) 2024 NHDES Subsurface Bureau Update

David Aiton

An overview of recent changes in the NHDES Subsurface Bureau including the updated license renewal process, recently passed legislation and additional topics related to NHDES individual sewage disposal system and subdivision applications.

Dave is the Compliance & Outreach Supervisor for the Subsurface Bureau of the New Hampshire Department of Environmental Services (NHDES). Prior to his role as a regional inspector and outreach specialist with NHDES, he worked for over 18 years in the civil engineering field for survey and engineering firms in New Hampshire's lakes region.

11:15 AM - 12:15 PM
Merrimack Room

0.25 NH LLS CEUs



Lunch

Schedule Subject to Change -
Updates will be emailed, along with
reminders of upcoming deadlines.

WORKSHOPS ★ FRIDAY, DECEMBER 6th

NHLSA 55th Annual Meeting & Equipment Show



(14) Exclusive Viewing of Exhibit Hall

This is a great opportunity to see some of the latest products and services the vendors have to offer. You will have the opportunity to see demonstrations, ask questions and perhaps make a purchase or two. You just may find that key piece of information, a helpful hint, or some new equipment that you were looking for to help you out with that tough project back at the office.

If you make a point to stop by each booth, the vendors will stamp your vendor card provided at sign in, and you will receive the 0.5 CEU credit for your time spent. See page 18 for a list of reserved exhibitors.

12:00 PM - 2:00 PM
Armory

0.50 NH LLS CEUs
With Vendor Card



(15) Encore Performance: Social Media and the Professional Surveyor

Timothy W. Burch, PLS

2:00 PM - 3:00 AM
Pemigewasset Room

0.25 NH LLS CEUs

(16) No, This is Not OK and other Essential Lessons on Total Station and Level Use

A. Richard Vannozzi, PLS

The practicing Land Surveyor still must break out their trusty tripod instruments every now and again, even if the magic GNSS "stick" is their preferred tool. This session will go over best practices in the set up, use, upkeep and calibration of these instruments. Best practices and "rules of thumb" for field operations will be discussed. Basic error propagation concepts that demand adherence to these methods will also be explained.

Attendees will leave with a laundry list of numerous field methods and techniques that they can begin implementing immediately without any real increase in time or cost.

Mr. Vannozzi is a graduate of the University of Maine where, in 1984, he earned a BS in Forestry and, in 2006, earned an MS in Forestry, both with a surveying emphasis.

Mr. Vannozzi has taught surveying across New England since 2003. Most recently, Mr. Vannozzi joined the faculty of the Surveying Engineering Technology program at The University of Maine in the Fall of 2019 where he teaches courses across the curriculum both in the traditional classroom and online.

He is registered as a Professional Land Surveyor in Massachusetts. He is a Past-President of the Massachusetts Association of Land Surveyors and Civil Engineers (MALSCE) and, in 1998, was recognized as MALSCE's Surveyor of the Year. Mr. Vannozzi was the 2012 recipient of ACSM's Earle J. Fennell Award for distinguished educational contributions to ACSM and the surveying and mapping profession. In 2017, Mr. Vannozzi was elected a Fellow of NSPS.

Mr. Vannozzi maintains a small consulting practice that specializes in complex boundary, title and zoning matters for select clients including attorneys and other Professional Land Surveyors.

2:00 PM - 4:00 PM
Dartmouth Room

0.50 NH LLS CEUs



Afternoon Break

Stay tuned for Session 16's photo. As Rich says, a picture is worth a thousand words.

Not available at press time, but will be included in the 55th Annual Meeting Booklet.

Don't forget to check off if you want a digital or hardcopy on the session selection page.

WORKSHOPS ★ FRIDAY, DECEMBER 6th

NHLSA 55th Annual Meeting & Equipment Show

(17) The Zoning Board of Adjustment: Strategies for Surveyors, Traps for the Unwary, and 2024 Updates in the Law

Brett Allard

Surveyors frequently represent landowners and other interested parties before local zoning boards. The seminar will discuss strategies for surveyors appearing before zoning boards to maximize their effectiveness, covering pre-application staff meetings and procedure, preparation and submission of applications, public hearing procedure and presentation tips, and post-hearing appeals. The seminar will also identify common traps and missteps to avoid in the world of increasingly complex real estate development statutes, regulations, and permitting procedures so that your clients are putting their strongest case forward from day one through the entire process. The seminar will conclude with a review of 2024 updates in zoning and planning law, including both legislative changes and NH Supreme Court decisions, along with discussion of how those updates could impact surveyors appearing before local zoning (and planning) boards moving forward.

Brett focuses his practice on real estate and land use law. He advises clients in all aspects of land planning, zoning, and real estate development matters, helping them navigate through the maze of local, state, and federal permitting. He is well-versed in handling all types of development projects, from basic lot line adjustments to large complex residential subdivisions, commercial projects, mixed use planned unit developments, and roadway issues. Brett previously worked with the New Hampshire Department of Environmental Services Wetlands Bureau and also has extensive experience representing clients in both residential and commercial lakefront and shoreland projects. He frequently represents clients before local zoning boards, planning boards, and other municipal bodies presenting all types of development proposals.



Brett also assists clients in real estate litigation cases, landlord tenant matters, and residential and commercial transactions, including acquisitions, dispositions, leasing, and financing.

Brett graduated from the University of New Hampshire School of Law as a member of its highly acclaimed Daniel Webster Scholar Honors Program.

When Brett isn't working, he enjoys spending his free time playing golf, hockey, snowboarding, and traveling.

2:00 PM - 4:00 PM
Contoocook Room

0.50 NH LLS CEUs

(18) Datum Modernization and NH State Coordinate System

Moderator

Craig T. Bailey, LLS, PE, PSM

Workshop Leaders

Stephen M. Ferguson, LLS

Mark Condodemetraky, LLS, PE

Dan Martin, North East NGS Advisor

Sit in on a working discussion with the leaders in the field of coordinates and datums! NGS is releasing an updated National Spatial Reference System (NSRS) consisting of four new **Terrestrial Reference Frames** and one new **Geopotential Datum**;

- ◆ Frames which are defined relative to the International Terrestrial Reference Frame (ITRF2020)
 - North America (NATRF2022)
 - Pacific (PATRF2022)
 - Caribbean (CATRF2022)
 - Mariana (MATRF2022)
- ◆ GEOID2022 – Gravity based geopotential datum

With the adoption of these new reference frames, and the deprecation of the US Survey Foot in favor of the International Foot as the official unit, the State of NH RSAs will need to be revised to officially adopt the new datums. Let's map out how NHLSA can help with this process.

Steve was a student of Bob Moynihan's at the Thompson School of Applied Science, University of New Hampshire, graduating in 1982. He has surveyed in NH, MA, ME, CT, RI, TX & WA with the predominate amount of his career spent working here in NH at John W. Durgin Associates and Norway Plains Associates. He is a Licensed Land Surveyor and Septic System Designer in the State of New Hampshire and is currently employed at NHDOT Right of Way in the Geodetic Survey Department. A current member of NHLSA & NSPS he served as the 52nd President of NHLSA. Steve is a resident of Concord, the father of four outstanding adults and spends most of his time at the family camp on Bow Lake in Strafford, NH.

Mark has been consulting for property owners and communities in the National Flood Insurance Program since 1994 and formerly served on the board of directors of the National Flood Association (NFA). A Licensed PE in ME, NH and VT and a Licensed Surveyor in NH and MA, Mark lives in the Lakes Region with his wife Andrea and their children.



2:00 PM - 4:00 PM
Merrimack Room

0.50 NH LLS CEUs

Reminder: Permitted Sewage Disposal System Designers & Installers and Natural Scientists—to receive credit, you must note your license number on the sign in/out sheets. Then send a copy to DES for credits.

Remember to sign in/out for each session to receive continuing education units (1/4 CEU for each hour session attended). Attendees must attend entire session to receive full credit.

WORKSHOPS ★ FRIDAY, DECEMBER 6th

NHLA 55th Annual Meeting & Equipment Show

(19) Young Surveyors Roundtable

Stefan Wollmar, LSIT

Please join your fellow Young Surveyors as we review our accomplishments from this past year, discuss ideas for the future, and cover an array of ongoing topics. We will discuss the recent interest in hosting in-person meetings in multiple regions once a month as well as compiling study material for the Professional Surveyor (PS) Exam. We will also be discussing our continued involvement in the national Young Surveyors Network, including the upcoming trip to Washington, D.C. Come prepared to share ideas and advice or just listen in on what is always an interesting assembly.

YSC 2024:

Our Young Surveyors Committee has been busy this year. Our monthly in-person meetings have led to five of our members becoming Surveyors In Training. We have compiled all of the study material one would need in order to study for the Fundamentals of Surveying (FS) Exam and we offer it freely to anyone who may want to learn. We have also volunteered at New Hampshire Construction Career Days (NHCCD) with the goal of introducing the next generation of surveyors to the profession.

Stefan is a Licensed Surveyor In Training (LSIT) and is currently employed at GM2 Associates, Inc. out of Concord, NH. He has been surveying for almost four years and has been involved in the Young Surveyors Committee for three of them. Before that he worked as an illustrator and graphic designer. Stefan is currently the Chair of the YSC and the Merchandise Chair of NHLA. Attributing much of his recent success in the survey field to being involved with NHLA and the YSC, Stefan proudly hosts monthly in-person meetings where young surveyors from around the state can gather to share information and socialize. Determined to become a licensed Land Surveyor, his next focus will be on developing his portfolio and studying for the PS Exam. Recently married, Stefan enjoys spending his free time with his wife and two dogs.

2:00 PM - 4:00 PM
Piscataquog Room

0.50 NH LLS CEUs



Stefan at NH Construction Career Days



Thank you
for
attending!

NHLSA BOOKSTORE ★ 2025 GOALS MEETING

NHLSA 55th Annual Meeting & Equipment Show

NHLSA BOOKSTORE

Don't forget to stop by the traveling NHLSA Bookstore during the breaks and free time. This is the perfect time to save that 25% shipping & handling charge. Barbara and our devoted volunteers will have a mini bookstore set up in the assembly area and will be selling all of the books and merchandise that you can normally purchase on the NHLSA website. With the end of the year right around the corner, books and reference material may also be good tax deduction business expenses for you, and if you are an aspiring surveyor, some of these books will be invaluable to you in preparing for your exam!

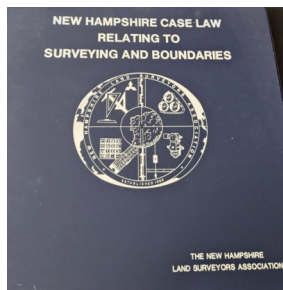

In addition to the reference books, we also have items like brass discs, lapel pins, and belt buckles. The belt buckles (with proceeds going towards the Scholarship Fund) are numbered sequentially, so if your license number falls between 194-513, you may be able to get a buckle with your license number on it.



*****Check out all items and prices in the NHLSA Bookstore located in the 55th Annual Booklet!*****



NHLSA GOALS & COMMITTEES

Please consider volunteering to become a chair of a vacant committee and/or join an ongoing committee. There are some committees with only one volunteer, for instance, the website. This committee could definitely use additional minds and hands.

NHLSA wouldn't survive without all the great volunteers.

Unfortunately, we are heading into this year's Annual Meeting without a Vice President and a Treasurer candidate.

Location: To Be Determined
January 11, 2025 - 9:00 A.M. – 3:00 P.M.



INTERNATIONAL
VOLUNTEERS DAY
DECEMBER 5th

THANK YOU

NHLSA 55th Annual Meeting & Equipment Show

Editor's Note: Although not a Sustaining Member, the Executive Committee contracted with AlphaGraphics to bind our 55th Annual Meeting Booklet, at a low reasonable cost. Last year, they also bound our 54th Annual Meeting Booklet at no cost. We would like to thank them with this one-page advertisement.

Welcome to AlphaGraphics Nashua. We are a local marketing and printing company located at 97 Main Street Nashua, New Hampshire 03060.

We are your premier marketing and printing solution - serving the Nashua market. Success of your business is your biggest priority, and ours as well. At AlphaGraphics Nashua we focus on results and the return-on-investment of your marketing dollars. We are your local visual marketing and communication experts, who truly care about product quality, customer satisfaction and establishing long-term partnerships with our clients.



Our Featured Services

OUR COMMITMENT

As a leading Marketing and Communication provider located in Southern New Hampshire, we recognize our success as determined solely by our commitment to you, our customers and their commitment to us. We excel in providing rapid response and full-service print solutions ranging from variable data printing to traditional offset and large format capabilities. Saying yes is our specialty. You name it we got it. Alphagraphics can help your business reach new heights. We believe in pushing boundaries using our state-of-the-art technology and equipment along with our dedicated and trained staff, together we can help you increase your reach.

THE TEAM

Of all the printing companies in southern New Hampshire, why should you trust AlphaGraphics with things as important as your marketing, communications, printing and imaging? The answer is simple: the experts at AlphaGraphics have the experience to give you exactly what your communications need. But we're not just the best at what we do, we also want you to be comfortable with the results, so we give you total control over the entire process, from the first little seed to the final product.

THE ALPHAGRAPHS DIFFERENCE

AlphaGraphics has been around for over 30 years, and we excel in providing quick turnaround and full-service solutions. Whether you want something like variable data printing or something more traditional like offset printing, we can take care of you. We are always pushing the limits of our state-of-the-art equipment, learning new techniques and experimenting so we can give you the most bang for your marketing buck.

INCREASE YOUR VISIBILITY

AlphaGraphics gives you as many options as you could want, including:

Traditional Offset Printing

Pamphlets

Books

Digital printing

Posters

Menus

Signs

Banners

Window decals

You shouldn't have to shop around to get all the printing options you want. At AlphaGraphics, we want to be your one-stop printing shop. Whether you need large-format printing for the exterior of a building, directional signs for the interior or window decals and vehicle wraps to make vehicles into rolling advertisements, we can help you.

GET NOTICED. GET BUSINESS. ®

Producing hard copies isn't the only thing we can help you with. Do you need help with your marketing strategy? Graphic design? Multi-channel marketing campaigns? The people at AlphaGraphics aren't just the fastest and friendliest people you can work with, but each member of our staff can give you the expert advice you need to make an impact on your target audience.

Come into AlphaGraphics today and see how you can increase your reach and get more out of your marketing than ever before.

Why AlphaGraphics?

Exceptional Service

We provide easy, best-in-class service to support your business needs.

Creative Mindset

We bring creativity and innovation to turn your dreams into reality.

Proven Expertise

For over 50 years, we've helped brands get noticed and get business.

Engaged Partnership

We believe in building relationships with our customers, because we are most successful when we work together.

EXHIBITORS ★ PARKING ★ NHLSA LOGO CONTEST

NHLSA 55th Annual Meeting & Equipment Show

ARMORY

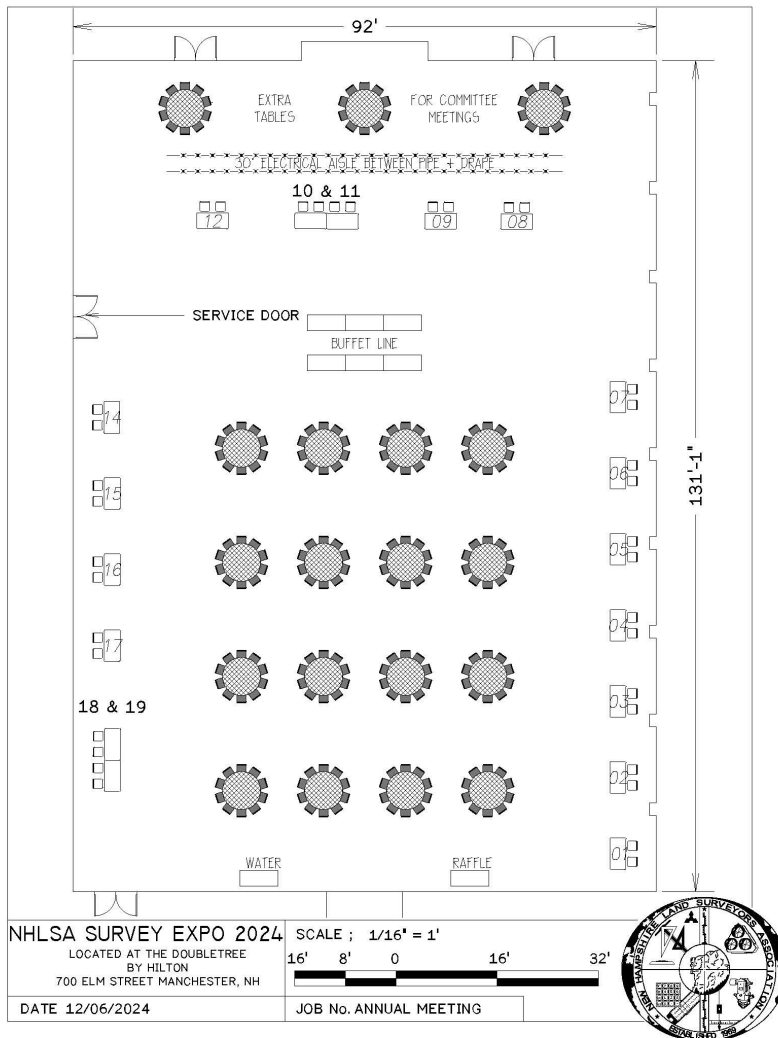

Exhibit Hours Set-Up

Installation
Friday, December 6
6:00 AM - 8:00 AM

Dismantle
Friday, December 6
3:30 PM - 4:00 PM

Thank You
2024 Exhibitors

Exhibit Hall Activity

Continental Breakfast
Friday
7:30 AM

Morning Break
Friday
10:00 AM

Lunch w/Exhibitors

Session 17:
**Exclusive Viewing
of Exhibits**

12:00 PM - 2:00 PM

Afternoon Break
Friday
3:00 PM

Booth: Exhibitor

- ◆ 1: New England Laser & Transit Company
- ◆ 2: National Geodetic Survey
- ◆ 3: National Society of Professional Surveyors
- ◆ 4: Topcon Solutions Store
- ◆ 5: Bluesky Geospatial Ltd.
- ◆ 6: Keystone Precision Solutions
- ◆ 7: Spiller's
- ◆ 8: Carlson Software

- ◆ 9: WSP USA
- ◆ 10 & 11: Maine Technical Source
- ◆ 12: UMaine
- ◆ 14: CADNET Services, LLC
- ◆ 15: Eastpoint Lasers
- ◆ 16 & 17: Stonex USA
- ◆ 18 & 19: Waypoint Technology Group

Note: Booth #13 has been eliminated and will be renumbered next year.

HOTEL INFORMATION

NHLSA 55th Annual Meeting & Equipment Show

The DoubleTree by Hilton Manchester Downtown, 700 Elm Street, Manchester, NH 03101.
Phone: 603-206-4216

**Room Rate: Single or Double \$159.00;
Triple \$169.00 + 8.5% tax/night.**

ROOM RESERVATION DEADLINE:

Reservations must be received on or before **November 13, 2024**. At this date, the hotel will review reservation pick up for the event and release the unreserved rooms for general sale.

To reserve an overnight room, click here:

<https://www.hilton.com/NHLSA24>

OVERNIGHT RESERVATION OF ROOMS:

1. A block of guestrooms is reserved for use of the NHLA Meeting/Show at group rates.
2. Individuals are responsible for securing their own reservations from this group

Identify yourself as attendees of the NHLA Group in order to receive the discount.

1. Check in is at 3:00 pm and check out is 11:00 am.
2. Cancellation, late arrival or special arrangements should be made directly with the DoubleTree.

Directions to Hotel: The DoubleTree by Hilton Manchester Downtown is located one hour from Boston, the White Mountains, Lakes Region and the Seacoast.

If you need further information, check out the hotel website at: <https://www.hilton.com/en/hotels/mhtmnt-doubletree-manchester-downtown/hotel-location/>

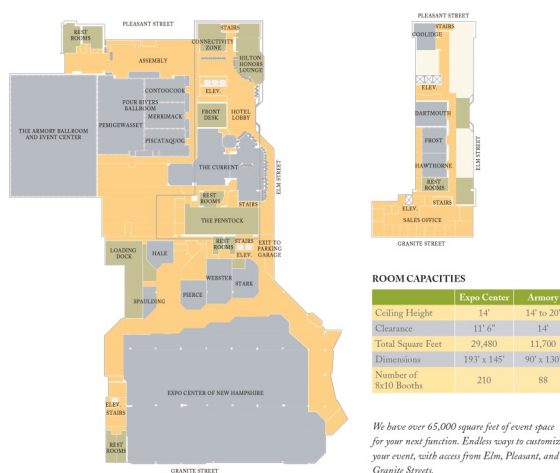

Room Name	Square Feet	Dimensions	Theater	Classroom	Reception	Round at 10	Hallway/Conference	U-Shape
Codage	532	19' x 28'	N/A	20	N/A	N/A	14	10
Dartmouth	891	27' x 33'	60	40	60	50	24	16
Frost or Hawthorne	702	27' x 26'	55	30	55	50	21	15
Frost & Hawthorne	1,404	54' x 26'	90	60	100	90	36	25
Four Rivers Ballroom	8,160	96' x 85'	850	500	900	560	N/A	N/A
Penigevassat or Contonook, Merrimack & Piscataway	4,080	85' x 48'	425	250	450	280	N/A	N/A
Contonook, Merrimack or Piscataway	1,344	28' x 48'	125	60	125	80	40	35
Contonook & Merrimack or Merrimack & Piscataway	2,736	57' x 48'	250	125	250	160	75	60
Amory	11,700	90' x 130'	1,200	650	1,200	800	N/A	N/A
Expo Center	29,480	193' x 145'	1,400	1,400	1,400	1,400	N/A	N/A
Stark	938	36' x 26'	75	45	75	70	28	24
Webster	1,115	41' x 36'	120	56	100	90	36	30
Pierce	774	39' x 27'	56	40	60	60	24	20
Hale	644	23' x 28'	50	24	50	50	21	18
Spaulding	420	33' x 13'	32	18	32	20	N/A	N/A

Parking

Convenient parking is available in the DoubleTree's attached garage.

This year's parking fees have been generously sponsored by Northam Survey and Jones & Beach Engineers.

Guests will receive a parking ticket as they enter the garage. They will also receive a parking pass with a QR code at the NHLA registration table.

Upon exiting the garage, guests should insert the original parking ticket, then scan the QR code. The gate will raise, and there will be no payment required.

NHLSA Logo Contest



The Executive Committee has authorized a contest for all to submit their logo design over the next several months, hopefully to have the logo selected and printed in time to letter the official NHLA Trailer for the Summer Quarterly in June 2025.

Please submit your design ideas to Barbara at the office using info@nhlsa.org. All entries must be received by April 1st in time for the April 2025 Executive Committee Meeting, which allows six (6) months for anyone interested in developing a logo to do so. Best of luck!

For more details, see the October issue of The TBM, page 8.

NHLSF BENEFIT AUCTION ★ THANK YOU FOR YOUR SUPPORT!

NHLSA 55th Annual Meeting & Equipment Show

BENEFIT AUCTION DONATION PLEDGE FORM

Don't miss the Fun, Food and Action at the NHLSA Benefit Auction!

Live Auction Thursday 6:00 - 7:00 PM (during the reception in the Penstock room)

Silent Auction ends Friday afternoon (winners announced end of day)

Use this form to make a donation to our Benefit Auction. Please complete the information below and return via fax, email or mail to **NHLSA** Office: 603-386-6856; info@nhlsa.org; PO Box 689, Raymond, NH 03077-0689.

Name / Company		Phone ()
Address		Fax ()
City	State	Zip
Item	Fair Market Value \$	

DOOR PRIZE DONATION:

RAFFLE DONATIONS

Please include a brief description of the item (s) to be used by auctioneer. **List additional items on separate piece of paper.**

Small items welcome for mini-raffle, drawing during Friday afternoon break.
50/50 raffle held throughout both days, closes at 2:00pm Friday, drawing during afternoon break

Please drop off
your item and form
at the registration table.

Please help in our recordkeeping by using the form below
when donating an auction item, door prize, or raffle prize.
Thank you for your cooperation and generosity!

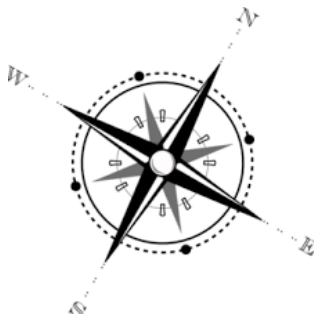

Thank you for your Support!!

2024 NHLSA CONVENTION REGISTRATION

NHLSA 55th Annual Meeting & Equipment Show

BEST VALUE

Early Bird Full Registration before November 8th—
\$400/\$300; If received after the November 22nd
final Deadline, add \$50

(✓) () LS () Associate () Affiliate () Student () Non-Member (add \$150 to registration)

Name	Guest Name
Company	Phone ()
Address	Email Address
City State Zip	Name on Badge

Member* (✓) () NHLSA () CALS () MALSCE () MSLS () RISPLS () VSLS () NYSAPLS
*Member includes all Northeast State Societies (If member in multiple states, check home state)

#	REGISTRATION	Member Early Bird	After Nov. 8th	TOTAL
	Full Registration - LLS	\$400.00	\$460.00	\$
	Full Registration - Tech	\$300.00	\$360.00	\$

*** Non-Member (add \$150 to registration) ***

	Thu Seminar Only (includes meals) - LLS	\$300.00	\$
	Thu Seminar Only (includes meals) - Tech	\$250.00	\$
	Thu All Day (see below) - LLS	\$330.00	\$
	Thu All Day (see below) - Tech	\$280.00	\$
	Fri Only (see below) - LLS	\$300.00	\$
	Fri Only (see below) - Tech	\$275.00	\$
	Banquet & Entertainment Only or Additional Tickets	\$70.00	\$
	Thu or Fri Lunch Ticket Only (includes breakfast & breaks)	\$55.00	\$
	Annual Meeting—please check for handout purposes	N/C	\$ N/C
	Past Presidents' Breakfast—RSVP REQUIRED	N/C	\$ N/C

Thursday All Day—includes workshops, continental breakfast, breaks, lunch, reception, banquet & entertainment.

Friday Only—includes workshops, continental breakfast, breaks, lunch, & equipment show.

Total Payment Due \$

Receive 20%* off for
five (5) or more
members or employees from
the same company

Register all employees on
website together in a single
order. Choose option to
bypass payment and request
a discounted invoice.

Method of Payment

Included in Full Registration

- ◆ Two Days of Workshops with CEUs
- ◆ Continental Breakfast (2)
- ◆ Morning & Afternoon Breaks (2)
- ◆ Lunch (2)
- ◆ Reception
- ◆ Banquet & Entertainment Equipment Show

Cancellation Policy
Written cancellation request must be postmarked
10 days in advance for 100% refund.



Hotel Reservation Deadline

DoubleTree by Hilton
Downtown Manchester
700 Elm Street
Concord, NH 03101
603-206-4216

November 13, 2024

Identify Affiliation with NHLSA

Check (payable to NHLSA) () CHECK # VISA () MASTERCARD () AMERICAN EXPRESS () DISCOVER ()

Credit Card Number ____/____/____/____/____/____/____/____/____/____/____/____/____/____/____/____ Exp. Date ____/____

Name Appearing on Card CVV (security code)

Address if different from above

CARDMEMBER ACKNOWLEDGES RECEIPT OF GOODS AND SERVICES IN THE AMOUNT OF THE TOTAL SHOWN HEREON AND AGREES TO PERFORM THE OBLIGATIONS SET FORTH BY THE CARDHOLDERS AGREEMENT WITH THE ISSUER.

Today's Date ____/____/____

- ◆ All registrations must be accompanied with payment
- ◆ Reservations cannot be taken by phone.
- ◆ **Send both pages**
- ◆ **Only one person and guest (members are not guests) per registration form**
- ◆ Make copies if needed

Mail Form (do not email credit card info)

New Hampshire Land Surveyors Association (NHLSA)
PO Box 689
Raymond, NH 03077-0689

Phone: 603-895-4822

Email for inquiries: info@nhlsa.org

Website for brochure or to register: www.nhlsa.org

<https://nhlsa.org/meetinginfo.php?id=40>

WORKSHOP SELECTION

NHLSA 55th Annual Meeting & Equipment Show

WORKSHOPS

Thursday, December 5, 2024		
✓	#	Title · Room · Times · Continuing Education Units
	1	Professional Track: Timothy W. Burch, PLS • Pemigewasset Room • 8:00 AM - 4:00 PM • 2.0 NH CEUs
	2	Technician Track: Eric Salovitch & Tasha Huhta • Merrimack/Contoocook Rooms • 8:00 AM - 4:00 PM • 2.0 NH CEUs
Friday, December 6, 2024		
	3	Using GIS and Other Data in your CAD Plans · Pemigewasset Room · 8:00 AM - 10:00 AM · 0.50 NH CEUs
	4	NSPS Certified Survey Technicians (CST) Program · Dartmouth · 8:00 AM - 12:00 PM
	5	The Last Mile: Final Push for New Datums · Contoocook Room · 8:00 AM - 10:00 AM · 0.50 NH CEUs
	6	Social Media and the Professional Surveyor · Merrimack Room · 8:00 AM - 9:00 AM · 0.25 NH CEUs
	7	Accuracy & Precision 2024 · Merrimack Room · 9:00 AM - 10:00 AM · 0.25 NH CEUs
	8	Northeast Surveying Societies (NESS) Roundtable · Piscataquog Room · 9:30 AM - 10:30 AM · 0.25 NH CEUs
	9	AutoCAD and Civil3D Intermediate Skills · Pemigewasset Room · 10:30 AM - 12:30 AM · 0.50 NH CEUs
	10	Practical Solutions for Surveying with GPS · Contoocook Room · 10:15 AM - 12:15 PM · 0.50 NH CEUs
	11	Shoreland—TBD · Merrimack Room · 10:15 AM - 11:15 AM · 0.25 NH CEUs
	12	Women in Surveying · Piscataquog Room · 10:30 AM - 12:30 PM · 0.50 NH CEUs
	13	NHDES Subsurface Bureau Update · Merrimack Room · 11:15 AM - 12:15 PM · 0.25 NH CEUs
	14	Exclusive Viewing of Exhibit Hall · Armory · 12:00 PM - 2:00 PM · 0.50 NH CEUs with submitted vendor card
	15	Encore: Social Media and the Professional Surveyor · Pemigewasset · 2:00 PM - 3:00 PM · 0.25 NH CEUs
	16	No, This is Not OK · Dartmouth Room · 2:00 PM - 4:00 PM · 0.50 NH CEUs
	17	The Zoning Board of Adjustment · Contoocook Room · 2:00 PM - 4:00 PM · 0.50 NH CEUs
	18	Datum Modernization and NH State Coordinate System · Merrimack Room · 2:00 PM - 4:00 PM · 0.50 NH CEUs
	19	Young Surveyors Roundtable + Social Media & the PS · Piscataquog Room · 2:00 PM - 4:00 AM · 0.50 NH CEUs
Reminder: Badge & meal tickets required for all events!		

Would you like a hardcopy 55th Annual Meeting Booklet? YES ☐ NO ☐

Would you like a 2025 Souvenir Calendar? YES ☐ NO ☐

CONVENTION REGISTRATION

IMPORTANT—Please help our speakers plan their handout material by filling out which workshops you plan to attend.

Please fill out both sides of the two-page registration form completely, and mail with payment to NHLSA. If paying by credit card, fax both sides, or register on the website.

EARLY BIRD FULL REGISTRATION—Save \$60 by registering before November 8th!

Thank You 2024 Presenters